

Tillable Soils Map

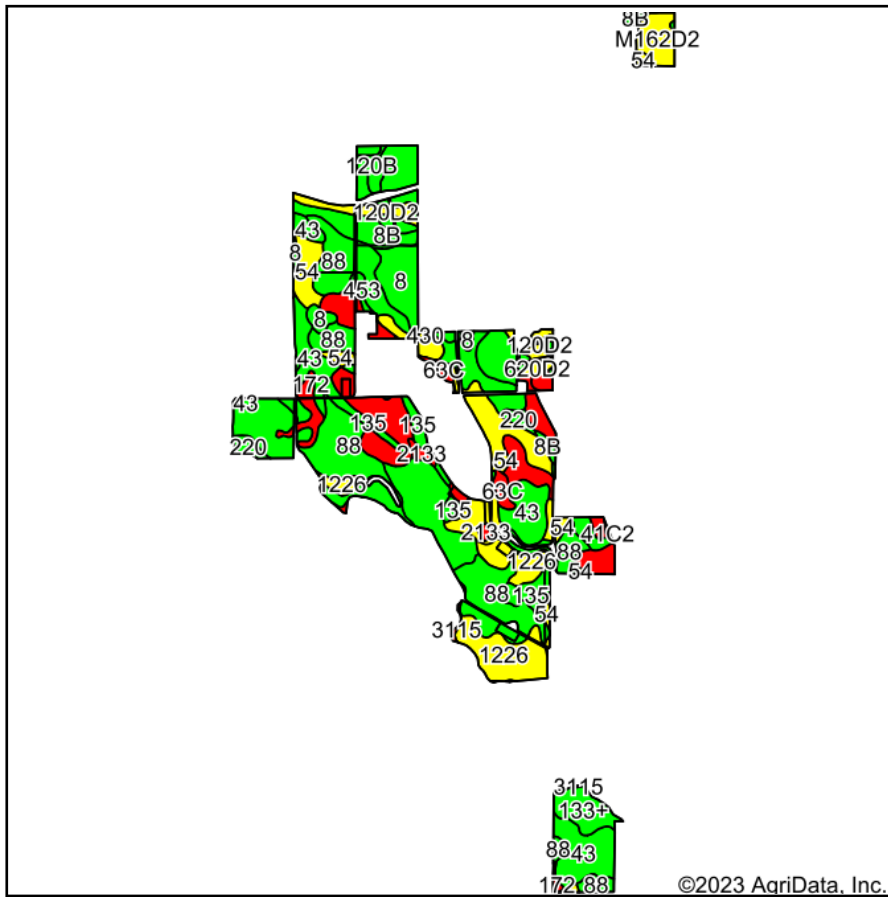

Soils data provided by USDA and NRCS.

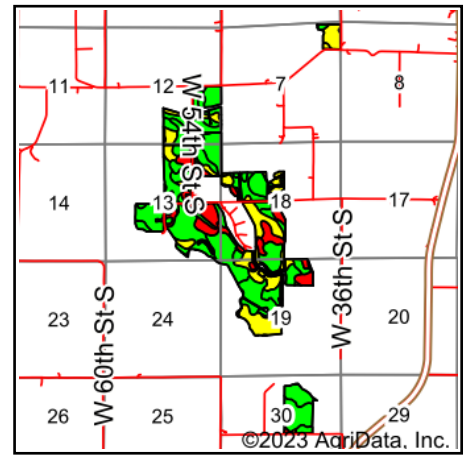

State: **Iowa**
 County: **Jasper**
 Location: **18-79N-19W**
 Township: **Palo Alto**
 Acres: **844**
 Date: **4/10/2023**



Maps Provided By:



Area Symbol: IA099, Soil Area Version: 28

Code	Soil Description	Acres	Percent of field	CSR2 Legend	Non-Irr Class *c	Irr Class *c	*j Corn Bu	*j Soybeans Bu	CSR2**	CSR	*n NCCPI Overall
88	Nevin silty clay loam, 0 to 2 percent slopes	191.54	22.8%		Is		227.2	65.9	92	90	96
43	Bremer silty clay loam, 0 to 2 percent slopes, occasionally flooded	128.89	15.4%		IIw		198.4	57.5	74	82	77
54	Zook silty clay loam, 0 to 2 percent slopes, occasionally flooded	83.94	10.0%		IIw		177.6	51.5	60	70	61
172	Wabash silty clay, 0 to 2 percent slopes	69.40	8.3%		IIIw		177.6	51.5	38	45	49
1226	Lawler loam, 0 to 2 percent slopes, rarely flooded	58.83	7.0%		IIIs		80.0	23.2	59	78	83
8B	Judson silty clay loam, 2 to 5 percent slopes	45.65	5.4%		IIe		230.4	66.8	93	90	95
135	Coland clay loam, 0 to 2 percent slopes, occasionally flooded	44.64	5.3%		IIw		198.4	57.5	76	80	83
133+	Colo silt loam, 0 to 2 percent slopes, occasionally flooded, overwash	43.48	5.2%		IIw		204.8	59.4	78	85	82
8	Judson silt loam, 0 to 2 percent slopes	35.39	4.2%		Ie		232.0	67.3	98	95	95
120C2	Tama silty clay loam, 5 to 9 percent slopes, eroded	25.23	3.0%		IIIe		211.2	61.2	87	76	89
M162D2	Downs silt loam, till plain, 9 to 14 percent slopes, eroded	17.68	2.1%		IVe		0.0	0.0	57		81
120D2	Tama silty clay loam, 9 to 14 percent slopes, eroded	17.44	2.1%		IIIe		169.6	49.2	62	66	85
41B	Sparta loamy fine sand, 2 to 5 percent slopes	14.88	1.8%		IVs	IIe	140.8	40.8	39	43	34
41C2	Sparta loamy fine sand, 5 to 9 percent slopes, moderately eroded	10.02	1.2%		IVs		120.0	34.8	30	25	31
120B	Tama silty clay loam, 2 to 5 percent slopes	9.01	1.1%		IIe		232.0	67.3	95	93	97
220	Nodaway silt loam, shallow loess, 0 to 2 percent slopes, occasionally flooded	8.87	1.1%		IIw		211.2	61.2	77	85	88
63C	Chelsea loamy fine sand, 5 to 9 percent slopes	7.97	0.9%		IVs		88.0	25.5	14	26	32

2133	Colo silty clay loam, 0 to 2 percent slopes, ponded, occasionally flooded	7.72	0.9%		Vw				35		11
20C2	Killduff silty clay loam, 5 to 9 percent slopes, eroded	5.01	0.6%		Ille		206.4	59.9	81	73	87
453	Tuskeego silt loam, 0 to 1 percent slopes	3.47	0.4%		Illw		80.0	23.2	81	58	91
63D	Chelsea loamy fine sand, 9 to 14 percent slopes	3.32	0.4%		Vls		88.0	25.5	5	11	30
620D2	Port Byron silt loam, 9 to 14 percent slopes, moderately eroded	3.26	0.4%		Ille		177.6	51.5	59	65	82
3115	Colo, overwash-Lawson complex, channeled, 0 to 2 percent slopes, frequently flooded	1.97	0.2%		Vw		80.0	23.2	5	5	11
430	Ackmore silt loam, 0 to 2 percent slopes, occasionally flooded	0.75	0.1%		Ilw		203.2	58.9	70	83	91
20E2	Killduff silty clay loam, 14 to 18 percent slopes, eroded	0.61	0.1%		IVe		153.6	44.5	44	53	78
M162C2	Downs silt loam, till plain, 5 to 9 percent slopes, eroded	0.31	0.0%		Ille		0.0	0.0	82		85
314	Lawson-Nodaway-Colo Complex, 0 to 2 percent slopes, occasionally flooded	0.22	0.0%		Ilw		80.0	23.2	77	75	89
Weighted Average					2.05	*-	186.3	54	72.6	*-	*n 78.6

**IA has updated the CSR values for each county to CSR2.

*- CSR weighted average cannot be calculated on the current soils data, use prior data version for csr values.

*i Yield data provided by the ISPAID Database version 8.1.1 developed by IA State University.

*n: The aggregation method is "Weighted Average using all components"

*c: Using Capabilities Class Dominant Condition Aggregation Method

*- Irr Class weighted average cannot be calculated on the current soils data due to missing data.

Soils data provided by USDA and NRCS.