

# Soils Map

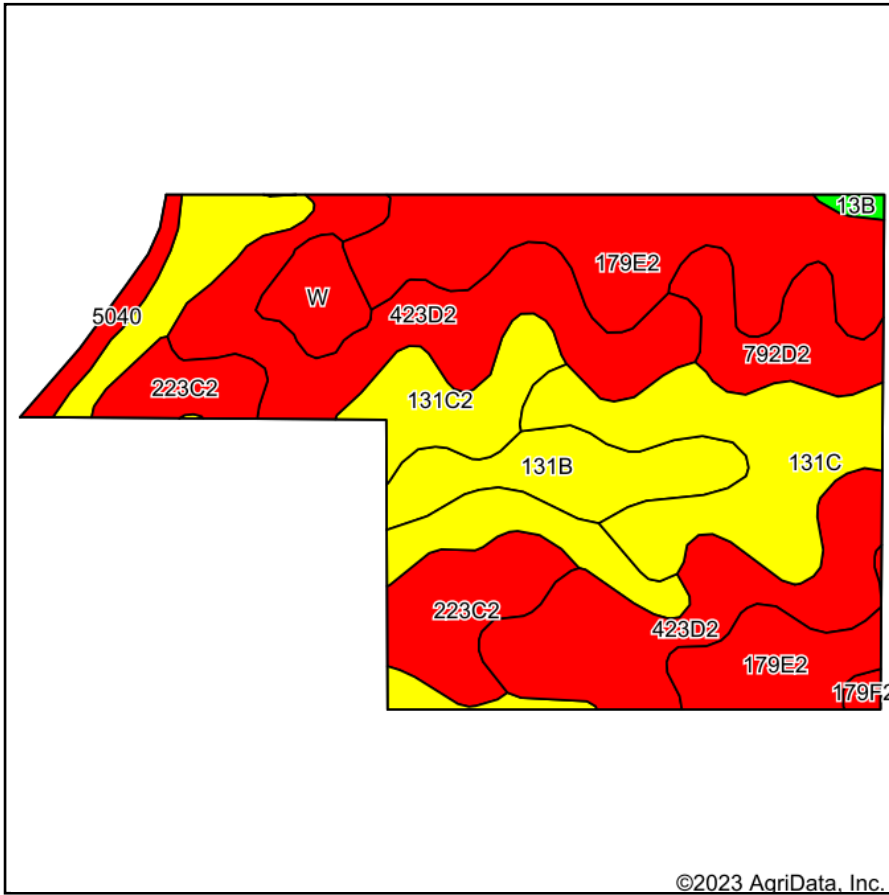

Soils data provided by USDA and NRCS.

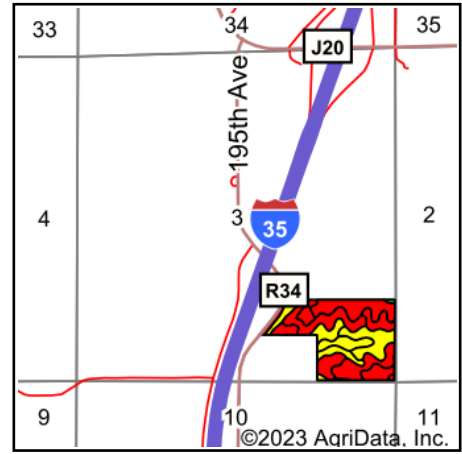

State: **Iowa**  
 County: **Decatur**  
 Location: **3-69N-26W**  
 Township: **Decatur**  
 Acres: **49**  
 Date: **2/14/2023**



Maps Provided By:



© AgriData, Inc. 2021

www.AgriDataInc.com



Area Symbol: IA053, Soil Area Version: 28

Code	Soil Description	Acres	Percent of field	CSR2 Legend	Non-Irr Class *c	CSR2**	CSR	*n NCCPI Overall	*n NCCPI Corn	*n NCCPI Small Grains	*n NCCPI Soybeans
423D2	Bucknell clay loam, 9 to 14 percent slopes, moderately eroded	12.83	26.2%		IVe	8	13	55	54	55	39
179E2	Gara clay loam, 14 to 18 percent slopes, moderately eroded	9.90	20.2%		VIe	23	33	63	63	49	42
131C2	Pershing silty clay loam, 5 to 9 percent slopes, moderately eroded	7.24	14.8%		IIIe	62	45	68	68	65	56
131C	Pershing silt loam, 5 to 9 percent slopes	6.10	12.4%		IIIe	65	49	72	72	69	58
223C2	Rinda silty clay loam, 5 to 9 percent slopes, moderately eroded	4.38	8.9%		IVw	45	22	60	60	52	46
131B	Pershing silt loam, 2 to 5 percent slopes	3.26	6.7%		IIIe	70	67	74	74	71	59
792D2	Armstrong clay loam, 9 to 14 percent slopes, moderately eroded	2.68	5.5%		IVe	7	13	57	57	49	40
W	Water	1.32	2.7%			0	0				
5040	Orthents, loamy	0.86	1.8%			5	5				
179F2	Gara clay loam, 18 to 25 percent slopes, moderately eroded	0.23	0.5%		IVe	11	13	52	52	33	34
13B	Olmitz-Zook-Vesser complex, 0 to 5 percent slopes	0.20	0.4%		IIw	76	55	79	76	55	74
<b>Weighted Average</b>					<b>*-</b>	<b>33.5</b>	<b>30.3</b>	<b>*n 60.1</b>	<b>*n 59.8</b>	<b>*n 54.9</b>	<b>*n 44.9</b>

\*\*IA has updated the CSR values for each county to CSR2.

\*n: The aggregation method is "Weighted Average using all components"

\*c: Using Capabilities Class Dominant Condition Aggregation Method

\*- Non Irr Class weighted average cannot be calculated on the current soils data due to missing data.

Soils data provided by USDA and NRCS.