

# Tillable Soils Map

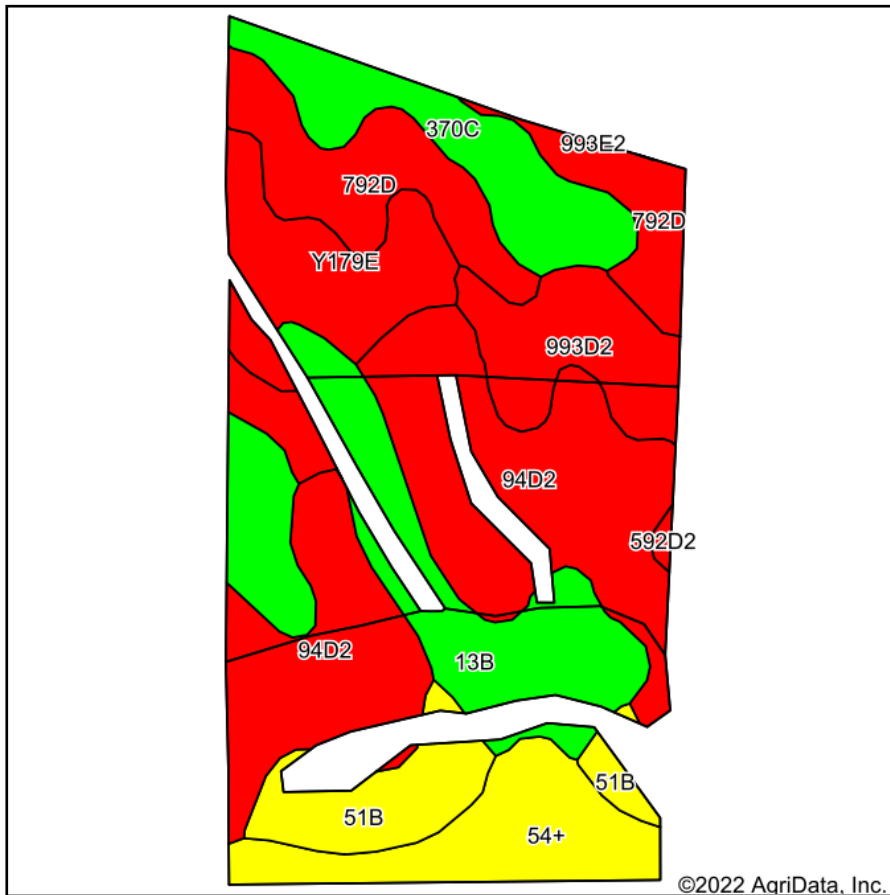

Soils data provided by USDA and NRCS.

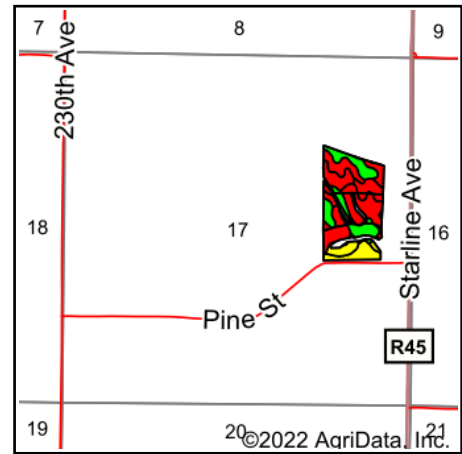

State: **Iowa**  
 County: **Clarke**  
 Location: **17-73N-25W**  
 Township: **Fremont**  
 Acres: **30.19**  
 Date: **10/21/2022**



Area Symbol: IA039, Soil Area Version: 27

Code	Soil Description	Acres	Percent of field	CSR2 Legend	Non-Irr Class *c	*i Corn Bu	*i Soybeans Bu	CSR2**	CSR	*n NCCPI Overall	
94D2	Mystic-Caleb complex, 9 to 14 percent slopes, moderately eroded	8.71	28.9%		IVe	120.0	34.8	20	20	72	
792D	Armstrong loam, 9 to 14 percent slopes	4.39	14.5%		IVe	99.2	28.8	9	18	64	
370C	Sharpsburg silty clay loam, 5 to 9 percent slopes	3.94	13.1%		IIIe	209.6	60.8	81	72	90	
13B	Olmitz-Zook-Colo complex, 0 to 5 percent slopes	3.34	11.1%		IIw	192.0	55.7	77	60	80	
54+	Zook silt loam, 0 to 2 percent slopes, occasionally flooded, overwash	2.77	9.2%		IIw	164.8	47.8	69	75	66	
Y179E	Gara loam, dissected till plain, 14 to 18 percent slopes	2.69	8.9%		VIe			37		80	
993D2	Gara-Armstrong clay loams, 9 to 14 percent slopes, moderately eroded	2.32	7.7%		IVe	123.2	35.7	30	20	69	
51B	Vesser silt loam, 2 to 5 percent slopes, occasionally flooded	1.95	6.5%		IIw	190.4	55.2	70	65	94	
592D2	Mystic clay loam, 9 to 14 percent slopes, moderately eroded	0.08	0.3%		IVe	88.0	25.5	10	5	69	
<b>Weighted Average</b>						<b>3.51</b>	<b>134.8</b>	<b>39.1</b>	<b>42.6</b>	<b>*.</b>	<b>*n 75.4</b>

\*\*IA has updated the CSR values for each county to CSR2.

\*- CSR weighted average cannot be calculated on the current soils data, use prior data version for csr values.

\*i Yield data provided by the ISPAID Database version 8.1.1 developed by IA State University.

\*n: The aggregation method is "Weighted Average using all components"

\*c: Using Capabilities Class Dominant Condition Aggregation Method

Soils data provided by USDA and NRCS.