

# Total Soils Map

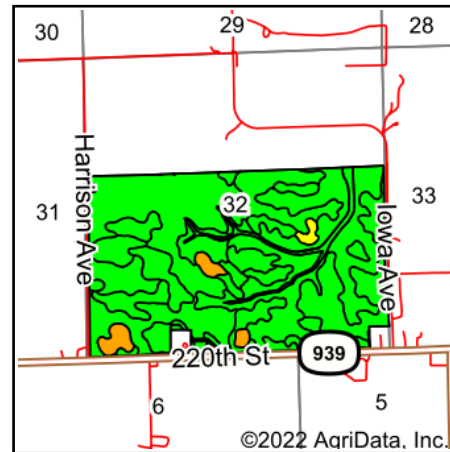

State: **Iowa**  
 County: **Buchanan**  
 Location: **32-89N-9W**  
 Township: **Washington**  
 Acres: **370.6**  
 Date: **9/21/2022**

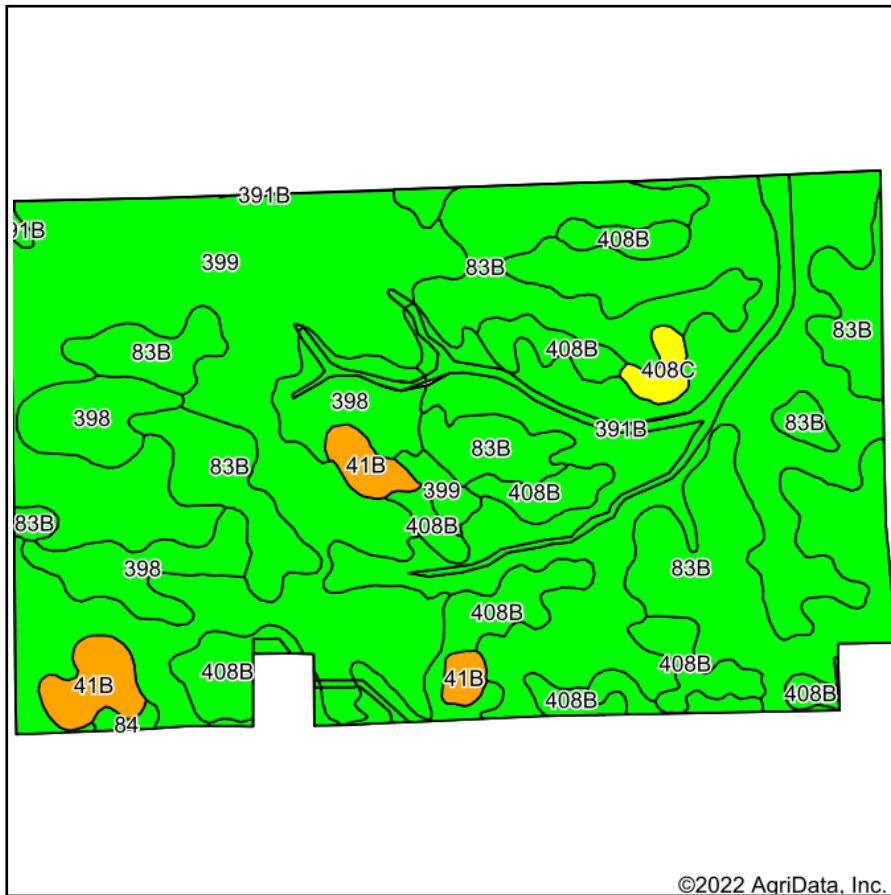

Maps Provided By:



© AgriData, Inc. 2021

www.AgriDataInc.com



Soils data provided by USDA and NRCS.

©2022 AgriData, Inc.

Area Symbol: IA019, Soil Area Version: 27

| Code                    | Soil Description                              | Acres  | Percent of field | CSR2 Legend | Non-Irr Class *c | CSR2**    |
|-------------------------|---|--------|------------------|-------------|------------------|-----------|
| 399                     | Readlyn silt loam, 1 to 3 percent slopes      | 111.13 | 30.0%            |             | lw               | 91        |
| 391B                    | Clyde-Floyd complex, 1 to 4 percent slopes    | 97.67  | 26.4%            |             | llw              | 87        |
| 83B                     | Kenyon loam, 2 to 5 percent slopes            | 88.05  | 23.8%            |             | lle              | 90        |
| 408B                    | Olin fine sandy loam, 2 to 5 percent slopes   | 33.47  | 9.0%             |             | lle              | 74        |
| 398                     | Tripoli clay loam, 0 to 2 percent slopes      | 27.05  | 7.3%             |             | llw              | 82        |
| 41B                     | Sparta loamy fine sand, 2 to 5 percent slopes | 9.81   | 2.6%             |             | IVs              | 39        |
| 408C                    | Olin fine sandy loam, 5 to 9 percent slopes   | 2.46   | 0.7%             |             | llle             | 65        |
| 84                      | Clyde clay loam, 0 to 3 percent slopes        | 0.96   | 0.3%             |             | llw              | 88        |
| <b>Weighted Average</b> |   |        |                  |             | <b>1.76</b>      | <b>86</b> |

\*\*IA has updated the CSR values for each county to CSR2.

\*c: Using Capabilities Class Dominant Condition Aggregation Method

Soils data provided by USDA and NRCS.