

Current CRP Soils Map

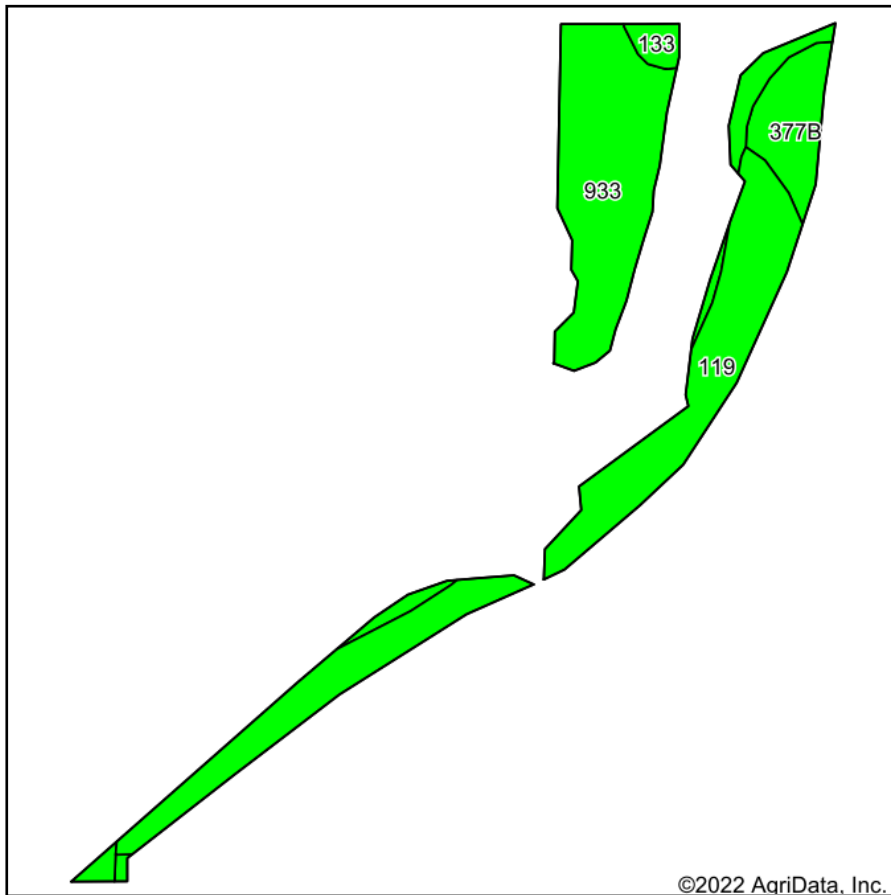

Soils data provided by USDA and NRCS.

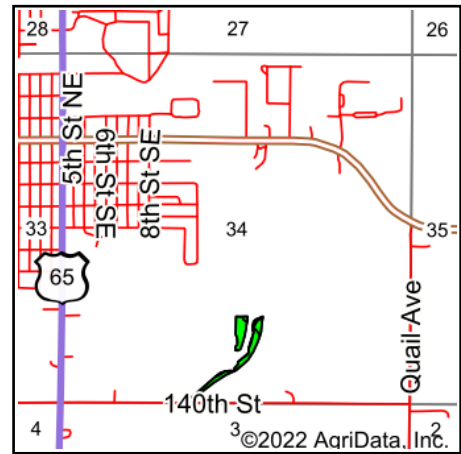

State: **Iowa**
 County: **Franklin**
 Location: **34-92N-20W**
 Township: **Hampton**
 Acres: **4.2**
 Date: **6/28/2022**



Maps Provided By:



Area Symbol: IA069, Soil Area Version: 28

Code	Soil Description	Acres	Percent of field	CSR2 Legend	Non-Irr Class *c	*i Corn Bu	*i Soybeans Bu	CSR2**	CSR	*n NCCPI Overall	
119	Muscatine silty clay loam, 0 to 2 percent slopes	1.91	45.5%		lw	240.0	69.6	100	100	96	
933	Sawmill silty clay loam, shallow loess, 0 to 2 percent slopes, occasionally flooded	1.73	41.2%		llw	204.8	59.4	78	80	77	
377B	Dinsdale silty clay loam, 2 to 5 percent slopes	0.46	11.0%		lle	232.0	67.3	94	90	87	
133	Colo silty clay loam, 0 to 2 percent slopes, occasionally flooded	0.10	2.4%		llw	204.8	59.4	78	80	77	
Weighted Average						1.55	223.8	64.9	89.8	90.2	*n 86.7

**IA has updated the CSR values for each county to CSR2.

*i Yield data provided by the ISPAID Database version 8.1.1 developed by IA State University.

*n: The aggregation method is "Weighted Average using all components"

*c: Using Capabilities Class Dominant Condition Aggregation Method

Soils data provided by USDA and NRCS.