

Soils Map

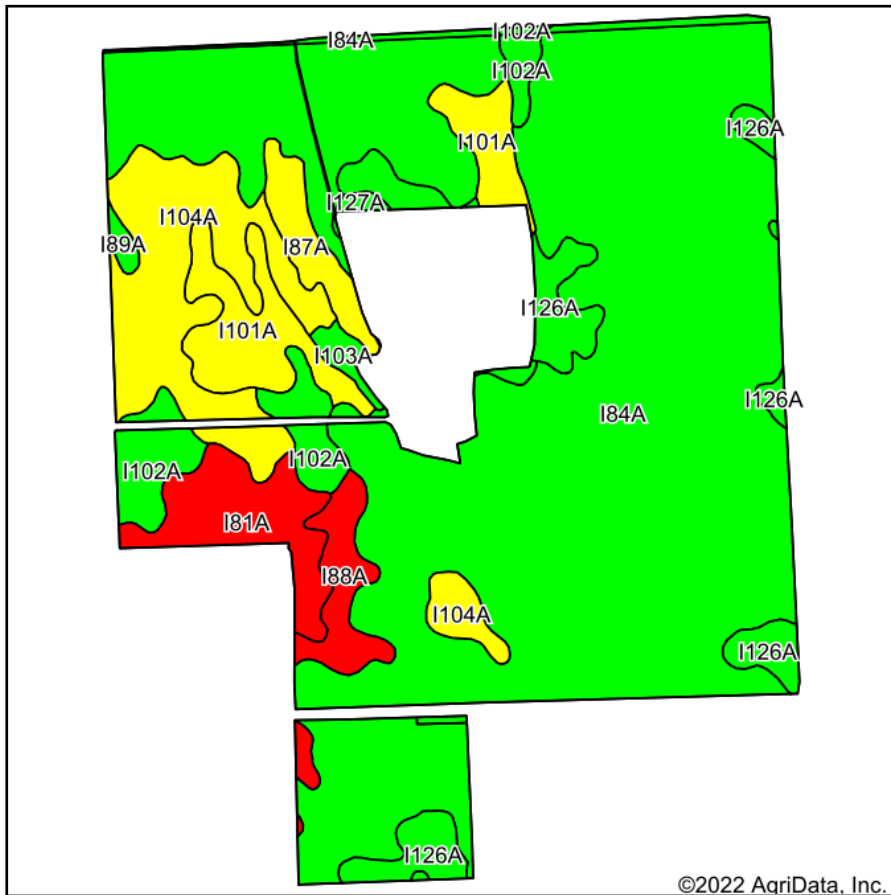

Soils data provided by USDA and NRCS.

©2022 AgriData, Inc.

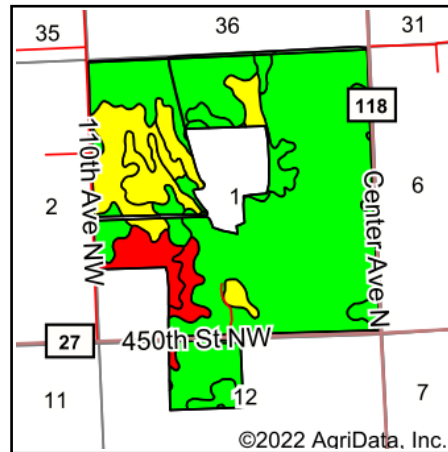

State: **Minnesota**
 County: **Marshall**
 Location: **1-158N-44W**
 Township: **East Park**
 Acres: **579.84**
 Date: **5/2/2022**



Maps Provided By:



Area Symbol: MN089, Soil Area Version: 21
 Area Symbol: MN135, Soil Area Version: 19

Code	Soil Description	Acres	Percent of field	PI Legend	Non-Irr Class *c	Productivity Index	*n NCCPI Overall	
I84A	Percy loam, 0 to 1 percent slopes, very cobbly	389.16	67.1%		III _s	70	39	
I104A	Strandquist loam, dense till, 0 to 1 percent slopes	52.59	9.1%		III _w	66	38	
I101A	Foxhome sandy loam, dense till, 0 to 2 percent slopes	29.72	5.1%		III _s	65	31	
I126A	Nereson fine sandy loam, 0 to 2 percent slopes	28.72	5.0%		II _c	82	37	
I81A	Northwood muck, dense till, 0 to 1 percent slopes	22.44	3.9%		VI _w	10	28	
I102A	Mavie fine sandy loam, dense till, 0 to 1 percent slopes	21.51	3.7%		III _w	75	30	
I88A	Haug muck, 0 to 1 percent slopes	13.71	2.4%		VI _w	15	28	
I87A	Pelan sandy loam, dense till, 0 to 2 percent slopes	10.41	1.8%		III _s	69	29	
I84A	Percy loam, 0 to 1 percent slopes, very cobbly	4.57	0.8%		III _s	70	40	
I103A	Kratka fine sandy loam, dense till, 0 to 1 percent slopes	2.83	0.5%		II _w	77	35	
I127A	Percy loam, 0 to 1 percent slopes	2.08	0.4%		II _w	85	39	
I89A	Nereson fine sandy loam, 0 to 2 percent slopes, very cobbly	1.63	0.3%		III _s	82	36	
I102A	Mavie fine sandy loam, dense till, 0 to 1 percent slopes	0.47	0.1%		III _w	75	30	
Weighted Average						3.13	66.6	*n 37.2

*n: The aggregation method is "Weighted Average using all components"

*c: Using Capabilities Class Dominant Condition Aggregation Method

Soils data provided by USDA and NRCS.