

# Tillable Soils Map

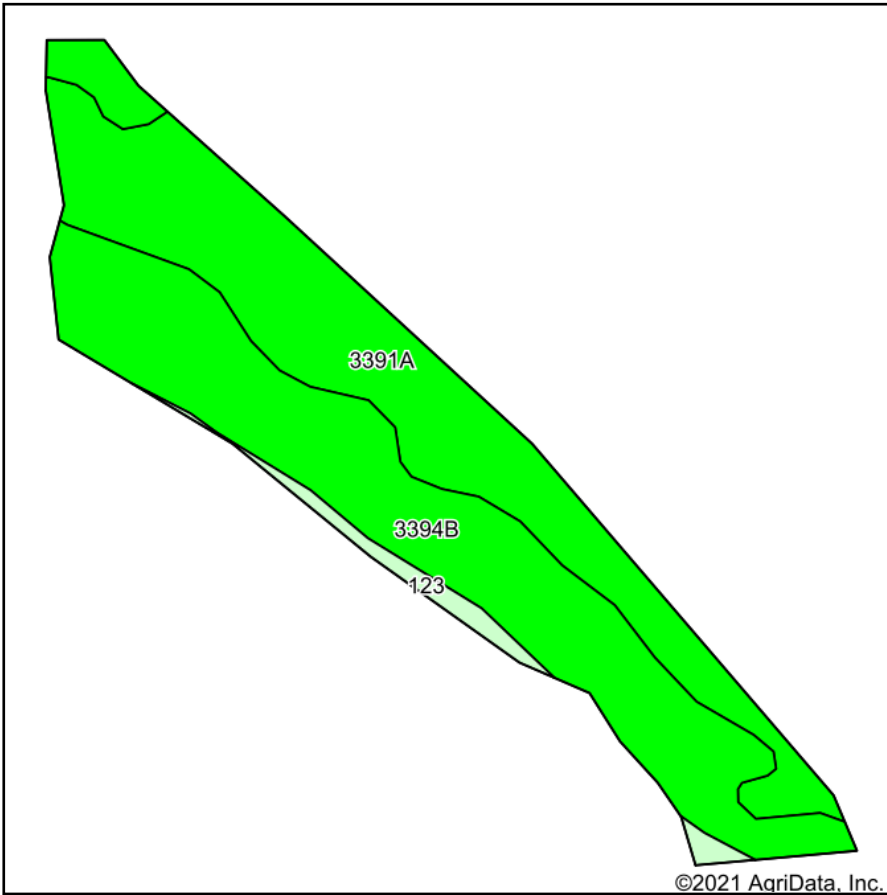

Soils data provided by USDA and NRCS.

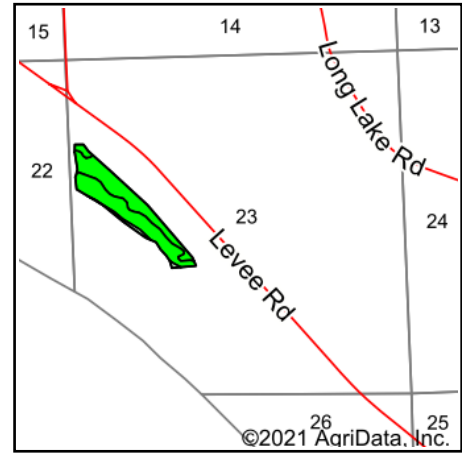

State: **Illinois**  
 County: **Monroe**  
 Location: **23-4S-11W**  
 Township: **Precinct 15**  
 Acres: **22.69**  
 Date: **12/28/2021**



Maps Provided By:



Area Symbol: IL133, Soil Area Version: 14

Code	Soil Description	Acres	Percent of field	II. State Productivity Index Legend	Crop productivity index for optimum management
3394B	Haynie silt loam, 2 to 5 percent slopes, frequently flooded	11.66	51.4%		118
3391A	Blake silty clay loam, 0 to 2 percent slopes, frequently flooded	10.16	44.8%		116
123	Riverwash	0.87	3.8%		
<b>Weighted Average</b>					<b>112.5</b>

**Table: Optimum Crop Productivity Ratings for Illinois Soil by K.R. Olson and J.M. Lang, Office of Research, ACES, University of Illinois at Champaign-Urbana.** Version: 1/2/2012 Amended Table S2 B811

Crop yields and productivity indices for optimum management (B811) are maintained at the following NRES web site: <http://soilproductivity.nres.illinois.edu/>

\*\* Indexes adjusted for slope and erosion according to Bulletin 811 Table S3

Soils data provided by USDA and NRCS. Soils data provided by University of Illinois at Champaign-Urbana.