

A Part of Section 23, Township 4 South, Range 11 West of the Third Principal Meridian, Monroe County, Illinois

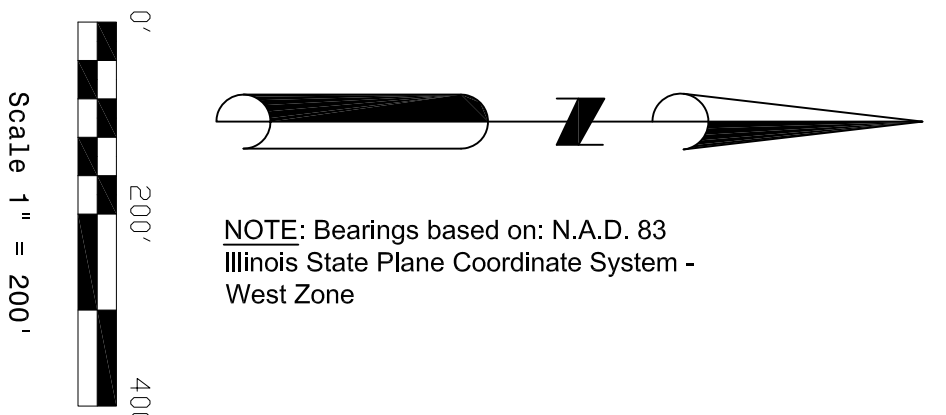

NOTE: Bearings based on: N.A.D. 83
Illinois State Plane Coordinate System - West Zone



LEGEND

These standard symbols will be found in the drawing.

○ 5/8" IRON PIN SET
● 1" IRON PIPE FOUND
○ P.O.B. POINT OF BEGINNING

Survey Metes and Bounds Description:

Parcel 1
The West Half of the Northeast Quarter, the Northeast Quarter of the Northwest Quarter, Part of the Southeast Quarter of the Northwest Quarter, Part of the North Half of the Northwest Quarter of the Southwest Quarter, Part of the North Half of the Northwest Quarter of the Southwest Quarter, and Part of the Southwest Quarter of the Northwest Quarter, all in Section 23, Township 4 South, Range 11 West of the Third Principal Meridian, Monroe County, Illinois being more particularly described as follows:

Beginning at an iron pin set at the Northeast corner of said West Half of the Northeast Quarter; thence South 00°30'41" West 3294.95 feet to an iron pipe found at the Southeast corner of said North Half of the Northeast Quarter of the Southwest Quarter; thence North 89°29'22" West 1241.58 feet along the South line of said North Half of the Northwest Quarter of the Southwest Quarter to an iron pin set in the Centerline of Levee Road; thence along said centerline North 40°07'49" West 1995.00 feet to an iron pin set; thence continuing along said centerline North 41°51'48" West 256.48 feet to an iron pin set; thence continuing along said centerline North 45°15'15" West 157.73 feet to an iron pin set at the Southwest corner of the Northwest Quarter; thence South 89°45'18" East 391.72 feet to an iron pin set at the Northwest corner of the Northwest Quarter of the Southwest Quarter; thence North 00°35'52" West 1392.10 feet to the Point of Beginning of said Parcel 1. Containing 173.775 acres, more or less.

Subject to the Right of Way of Levee Road along the entire Southwesterly side thereof. Subject also to any and all easements, rights of way, restrictions and covenants, recorded or otherwise.

Parcel 2
Part of the Southwest Quarter of the Northwest Quarter, Part of the North Half of the Northwest Quarter of the Southwest Quarter, Part of the North Half of the Northwest Quarter of the Southwest Quarter and Part of the Northwest Quarter of the Southwest Quarter, all in Section 23, Township 4 South, Range 11 West of the Third Principal Meridian, Monroe County, Illinois being more particularly described as follows:

Beginning at an iron pin set at the Northwest corner of said Southwest Quarter of the Northwest Quarter; thence South 89°45'18" East 907.68 feet along the South line of said Southwest Quarter to an iron pin set in the South line of said North Half of the Northwest Quarter of the Southwest Quarter; thence continuing along said centerline South 45°15'15" East 157.73 feet to an iron pin set; thence continuing along said centerline South 41°51'48" East 256.48 feet to an iron pin set; thence continuing along said centerline South 40°07'49" East 1995.00 feet to an iron pin set; thence North 89°29'22" West 1375.37 feet to the East bank of the Mississippi River; thence in Northwesterly direction along and with the remainder of said East bank a distance of 1898 feet, more or less, to the West line of said Southwest Quarter of said Northwest Quarter; thence North 01°54'21" West 857.08 feet along said West line to the Point of Beginning, containing 62.209 acres, more or less.

Subject to the Right of Way of Levee Road along the entire Northeastern side thereof. Subject also to any and all easements, rights of way, restrictions and covenants, recorded or otherwise.

- Surveyor's Notes:**
- Field work was completed for this survey July 30th, 2018.
 - This survey complies with the current Illinois minimum standards for a boundary survey.
 - I set or found the corner monuments as shown on the plat.
 - This surveyor has not made an investigation or independent search for easements of record, encumbrances, restrictive covenants, or ownership title evidence for this tract of land.

State of Illinois)
County of Wabash) S.S.

Surveyor's Certificate:

I, Trent J. McPeak, Illinois Professional Land Surveyor Number 035-003866, do hereby certify that at the request of Wamble Mountain Farms, LLC, I have caused a survey to be made and a plat to be drawn under my direction of the tracks of land as shown and described on this plat of survey. Signed and sealed this 1st day of August, 2018.

Trent J. McPeak, Illinois Professional Land Surveyor Number 035-003866.

Trent J. McPeak



<p>Design Firm No. 184-004365 Expires 4/30/2019</p> <p style="text-align: center;">NEIKIRK Engineering, LLC</p> <p style="text-align: center;">306 North Market Street Mt. Carmel, Illinois 62863 Phone: (618) 263-4100 Fax: (618) 263-4302 www.neirkirengineering.com</p> <p style="text-align: center;">Professional Engineering • Land Surveying Community Development Services</p>	<p>Boundary Survey</p> <p>Sec. 23, T4S, R11W, 3rd P.M.</p> <p>Monroe County, Illinois</p>	<p>REVISIONS: DATE</p>	<p>DWG. DATE: 08-01-2018</p>	<p>SHEET #: 1</p>	<p>OF 1 SHEETS</p> <p>DRAWING FILE: SEC.23.DWG</p>
---	---	---------------------------	----------------------------------	-----------------------	--