

Soils Map - Total Acres

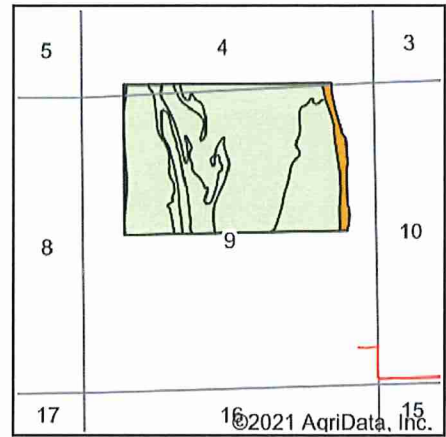

State: **Illinois**
 County: **Henderson**
 Location: **9-8N-6W**
 Township: **Lomax**
 Acres: **241.51**
 Date: **9/1/2021**

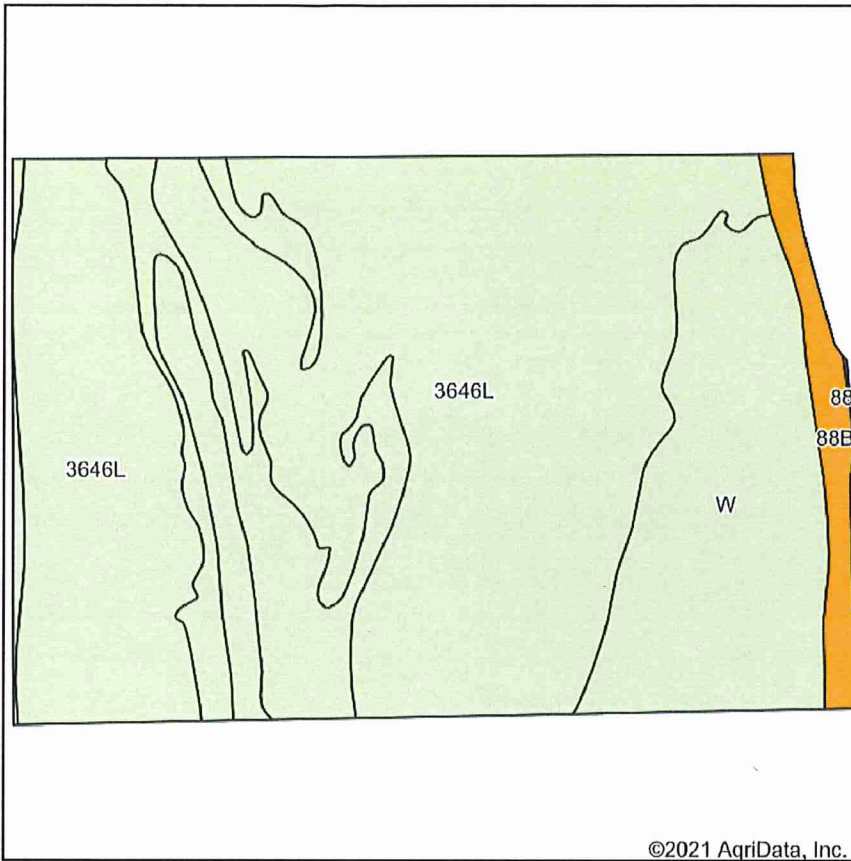

Maps Provided By:



© AgriData, Inc. 2021

www.AgriDataInc.com



Soils data provided by USDA and NRCS.

©2021 AgriData, Inc.

Area Symbol: IL071, Soil Area Version: 21

Code	Soil Description	Acres	Percent of field	Il. State Productivity Index Legend	Corn Bu/A	Soybeans Bu/A	Wheat Bu/A	Oats Bu/A <i>b</i>	Alfalfa <i>d</i> hay, T/A	Crop productivity index for optimum management
3646L	Fluvaquents, 0 to 2 percent slopes, frequently flooded, long duration	160.90	66.6%						.00	
W	Water	71.97	29.8%							
**88B	Sparta loamy sand, Illinois till plain, 2 to 6 percent slopes	8.58	3.6%		**118	**41	**50	**57	0.00	**91
88A	Sparta loamy sand, Illinois till plain, 0 to 2 percent slopes	0.06	0.0%		119	41	50	58	0.00	92
Weighted Average					3.6	0.8	1.1	1.4	-0.67	2.6

Table: Optimum Crop Productivity Ratings for Illinois Soil by K.R. Olson and J.M. Lang, Office of Research, ACES, University of Illinois at Champaign-Urbana. Version: 1/2/2012 Amended Table S2 B811

Crop yields and productivity indices for optimum management (B811) are maintained at the following NRES web site: <http://soilproductivity.nres.illinois.edu/>

** Indexes adjusted for slope and erosion according to Bulletin 811 Table S3

b Soils in the southern region were not rated for oats and are shown with a zero "0".

d Soils in the poorly drained group were not rated for alfalfa and are shown with a zero "0".

Soils data provided by USDA and NRCS. Soils data provided by University of Illinois at Champaign-Urbana.