

# Soils Map - FSA Tillable Acres

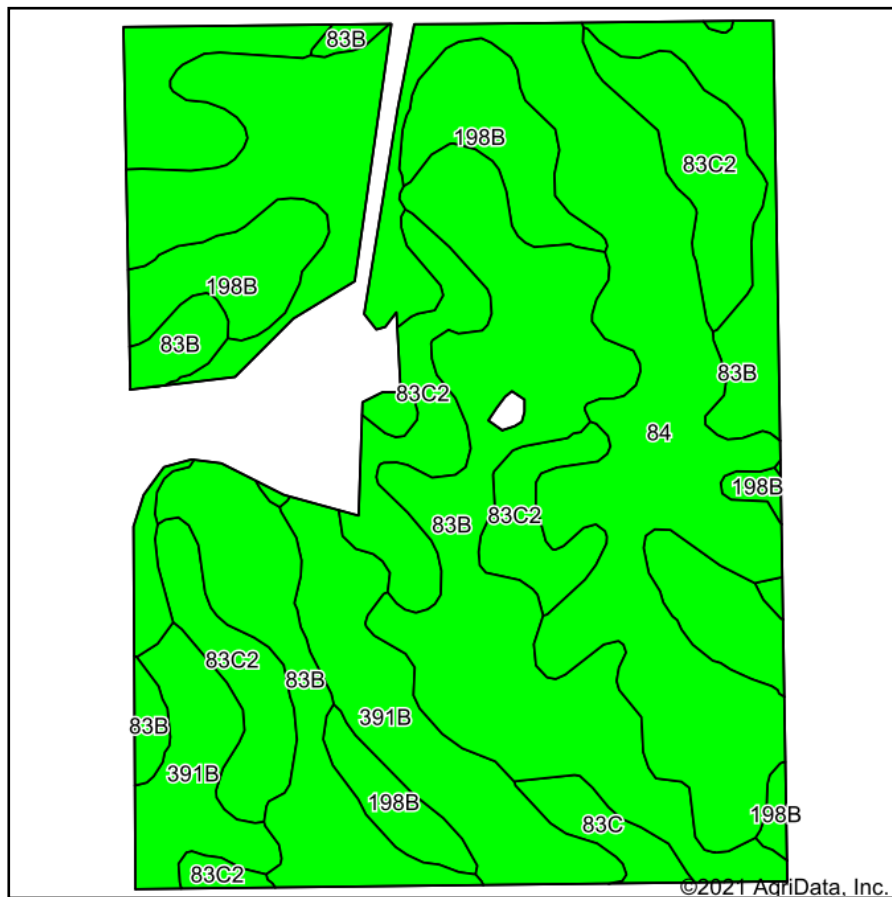

Soils data provided by USDA and NRCS.

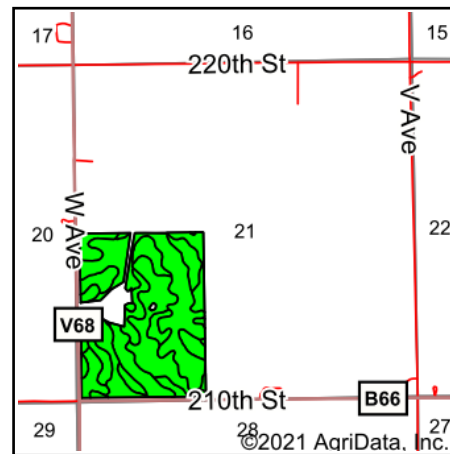

State: **Iowa**  
 County: **Fayette**  
 Location: **21-94N-10W**  
 Township: **Bethel**  
 Acres: **106.94**  
 Date: **7/12/2021**

**PC PEOPLES**  
 COMPANY  
 INNOVATIVE. REAL ESTATE. SOLUTIONS.

Maps Provided By:

**surety**  
 CUSTOMIZED ONLINE MAPPING  
 © AgriData, Inc. 2021 www.AgriDataInc.com



Area Symbol: IA065, Soil Area Version: 25

Code	Soil Description	Acres	Percent of field	CSR2 Legend	Non-Irr Class *c	*i Corn	*i Alfalfa	*i Soybeans	CSR2**	Corn	Oats	Soybeans	*n NCCPI Corn	*n NCCPI Soybeans
83B	Kenyon loam, 2 to 5 percent slopes	34.20	32.0%		Ille	225.6	6.3	65.4	90	210	91	61	90	78
84	Clyde clay loam, 0 to 3 percent slopes	31.80	29.7%		Ilw	224	4.7	65	88				90	85
83C2	Kenyon loam, 5 to 9 percent slopes, eroded	14.81	13.8%		Ille	204.8	5.7	59.4	84	212	88	61	83	66
198B	Floyd loam, 1 to 4 percent slopes	13.13	12.3%		Ilw	222.4	5.8	64.5	89				81	85
391B	Clyde-Floyd complex, 1 to 4 percent slopes	11.44	10.7%		Ilw	216	4.5	62.6	87				86	85
83C	Kenyon loam, 5 to 9 percent slopes	1.56	1.5%		Ille	209.6	5.9	60.8	85	188	90.5	48.5	89	76
<b>Weighted Average</b>						<b>220.6</b>	<b>5.5</b>	<b>64</b>	<b>88.1</b>	<b>99.3</b>	<b>42.6</b>	<b>28.7</b>	<b>*n 87.5</b>	<b>*n 80</b>

\*\*IA has updated the CSR values for each county to CSR2.

\*i Yield data provided by the ISPAID Database version 8.1.1 developed by IA State University.

\*n: The aggregation method is "Weighted Average using all components"

\*c: Using Capabilities Class Dominant Condition Aggregation Method

Soils data provided by USDA and NRCS.