

# Tillable Soils Map

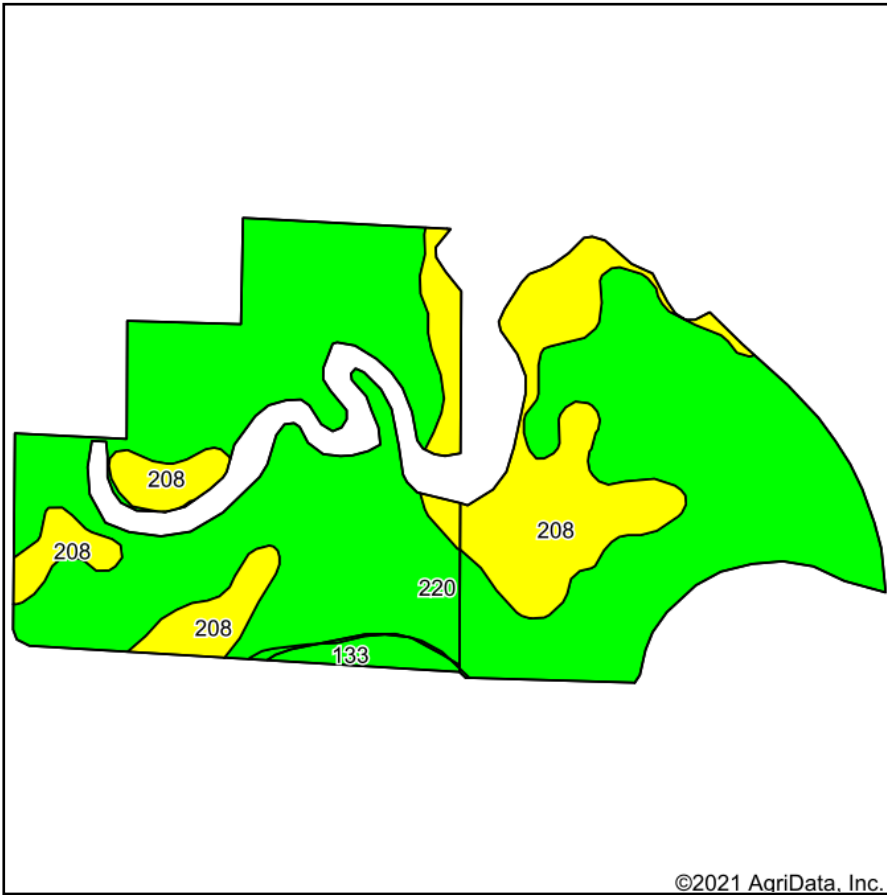

Soils data provided by USDA and NRCS.

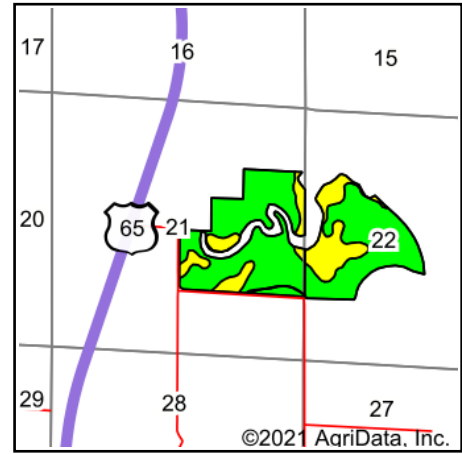

State: **Iowa**  
 County: **Polk**  
 Location: **21-78N-23W**  
 Township: **Allen**  
 Acres: **200.48**  
 Date: **6/28/2021**



Maps Provided By:



© AgriData, Inc. 2021

www.AgriDataInc.com



Area Symbol: IA153, Soil Area Version: 22

Code	Soil Description	Acres	Percent of field	CSR2 Legend	Non-Irr Class *c	CSR2**	CSR	*n NCCPI Overall	*n NCCPI Corn	*n NCCPI Soybeans
220	Nodaway silt loam, 0 to 2 percent slopes, occasionally flooded	152.00	75.8%		Ilw	82	85	96	95	95
208	Klum fine sandy loam, 0 to 2 percent slopes, occasionally flooded	44.90	22.4%		Ils	70	55	89	88	70
133	Colo silty clay loam, deep loess, 0 to 2 percent slopes, occasionally flooded	3.58	1.8%		Ilw	78	80	81	75	80
<b>Weighted Average</b>						<b>79.2</b>	<b>78.2</b>	<b>*n 94.2</b>	<b>*n 93.1</b>	<b>*n 89.1</b>

\*\*IA has updated the CSR values for each county to CSR2.

\*n: The aggregation method is "Weighted Average using all components"

\*c: Using Capabilities Class Dominant Condition Aggregation Method

Soils data provided by USDA and NRCS.