

FSA Tillable Soils Map

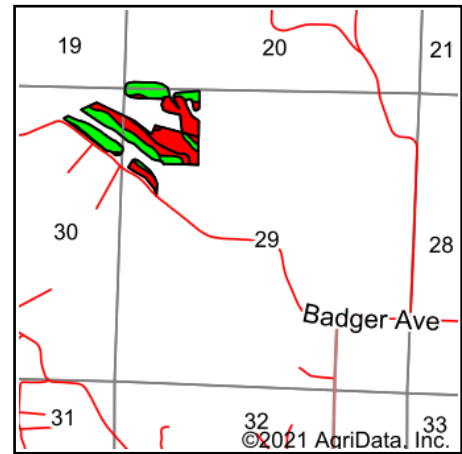

Soils data provided by USDA and NRCS.



State: **Iowa**
 County: **Pottawattamie**
 Location: **29-76N-43W**
 Township: **Hazel Dell**
 Acres: **39.56**
 Date: **5/13/2021**



Maps Provided By:



Area Symbol: IA155, Soil Area Version: 26

Code	Soil Description	Acres	Percent of field	CSR2 Legend	Non-Irr Class *c	*i Corn	*i Soybeans	CSR2**	CSR	*n NCCPI Overall
1E3	Ida silt loam, 14 to 20 percent slopes, severely eroded	19.79	50.0%		IVe	97.6	28.3	18	30	59
12B	Napier silt loam, 2 to 5 percent slopes	16.38	41.4%		Ile	230.4	66.8	93	77	90
12C	Napier silt loam, 5 to 9 percent slopes	1.34	3.4%		IIIe	214.4	62.2	89	62	87
2G	Hamburg silt loam, 40 to 75 percent slopes	0.86	2.2%		VIIe	88	25.5	5	5	17
10C2	Monona silt loam, 5 to 9 percent slopes, eroded	0.83	2.1%		IIIe	211.2	61.2	86	63	83
1F3	Ida silt loam, 20 to 30 percent slopes, severely eroded	0.36	0.9%		VIe	88	25.5	8	10	17
Weighted Average						158.6	46	52.5	50.5	*n 72

**IA has updated the CSR values for each county to CSR2.

*i Yield data provided by the ISPAID Database version 8.1.1 developed by IA State University.

*n: The aggregation method is "Weighted Average using all components"

*c: Using Capabilities Class Dominant Condition Aggregation Method

Soils data provided by USDA and NRCS.