

Soils Map

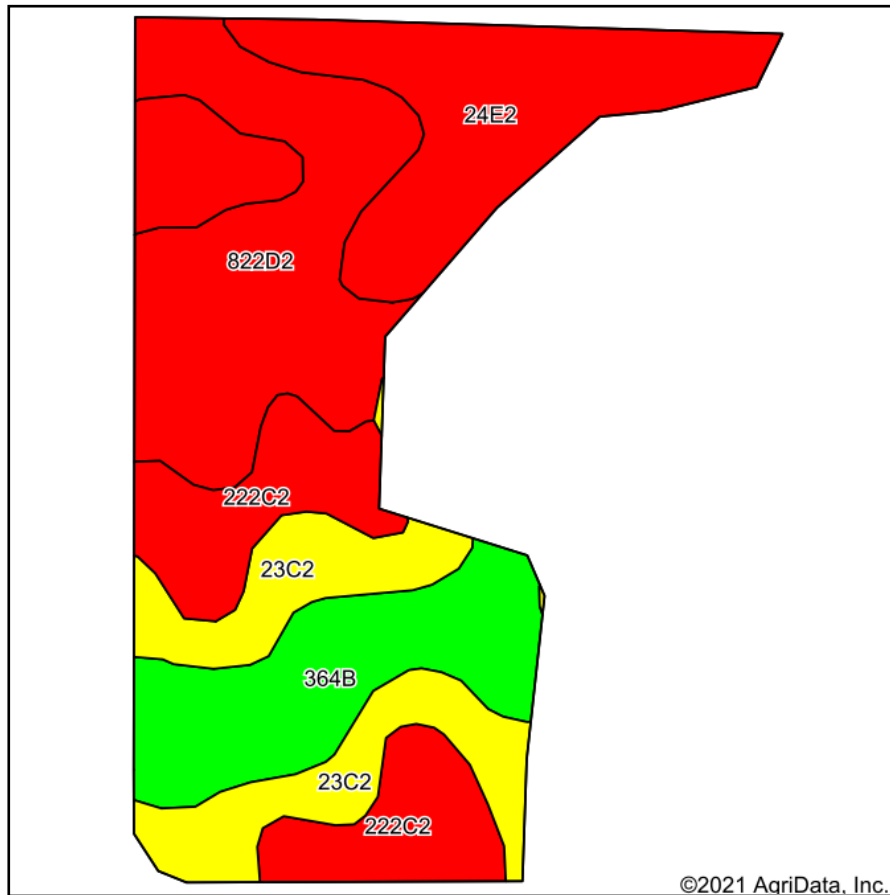

Soils data provided by USDA and NRCS.

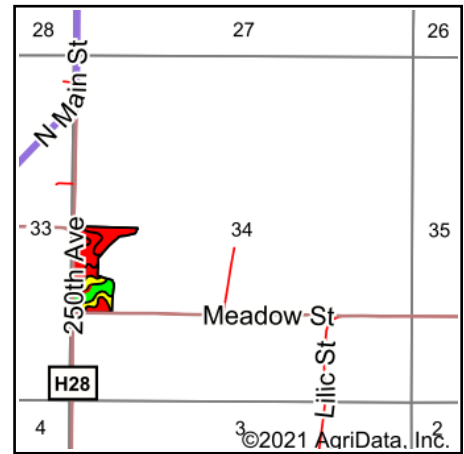

State: **Iowa**
 County: **Clarke**
 Location: **34-73N-25W**
 Township: **Fremont**
 Acres: **17.44**
 Date: **3/4/2021**

PC PEOPLES
 COMPANY
 INNOVATIVE. REAL ESTATE. SOLUTIONS.

Maps Provided By:

surety
 CUSTOMIZED ONLINE MAPPING
 © AgriData, Inc. 2021 www.AgriDataInc.com



Area Symbol: IA039, Soil Area Version: 26

| Code | Soil Description | Acres | Percent of field | CSR2 Legend | Non-Irr Class *c | CSR2** | CSR | *n NCCPI Overall | *n NCCPI Corn | *n NCCPI Small Grains | *n NCCPI Soybeans |
|------------------|--|-------|------------------|-------------|------------------|--------|------|------------------|---------------|-----------------------|-------------------|
| 822D2 | Lamoni clay loam, 9 to 14 percent slopes, moderately eroded | 4.46 | 25.6% | | IVe | 11 | 15 | 65 | 65 | 60 | 46 |
| 222C2 | Clarinda silty clay loam, 5 to 9 percent slopes, moderately eroded | 3.70 | 21.2% | | IVw | 28 | 25 | 55 | 55 | 48 | 43 |
| 24E2 | Shelby clay loam, 14 to 18 percent slopes, moderately eroded | 3.40 | 19.5% | | IVe | 40 | 33 | 67 | 67 | 53 | 50 |
| 23C2 | Arispe silty clay loam, 5 to 9 percent slopes, moderately eroded | 2.98 | 17.1% | | IIIe | 62 | 50 | 75 | 75 | 67 | 69 |
| 364B | Grundy silty clay loam, 2 to 5 percent slopes | 2.90 | 16.6% | | Ile | 72 | 75 | 80 | 80 | 68 | 68 |
| Weighted Average | | | | | | 39.1 | 36.6 | *n 67.5 | *n 67.5 | *n 58.6 | *n 53.7 |

**IA has updated the CSR values for each county to CSR2.

*n: The aggregation method is "Weighted Average using all components"

*c: Using Capabilities Class Dominant Condition Aggregation Method

Soils data provided by USDA and NRCS.