

# Soils Map

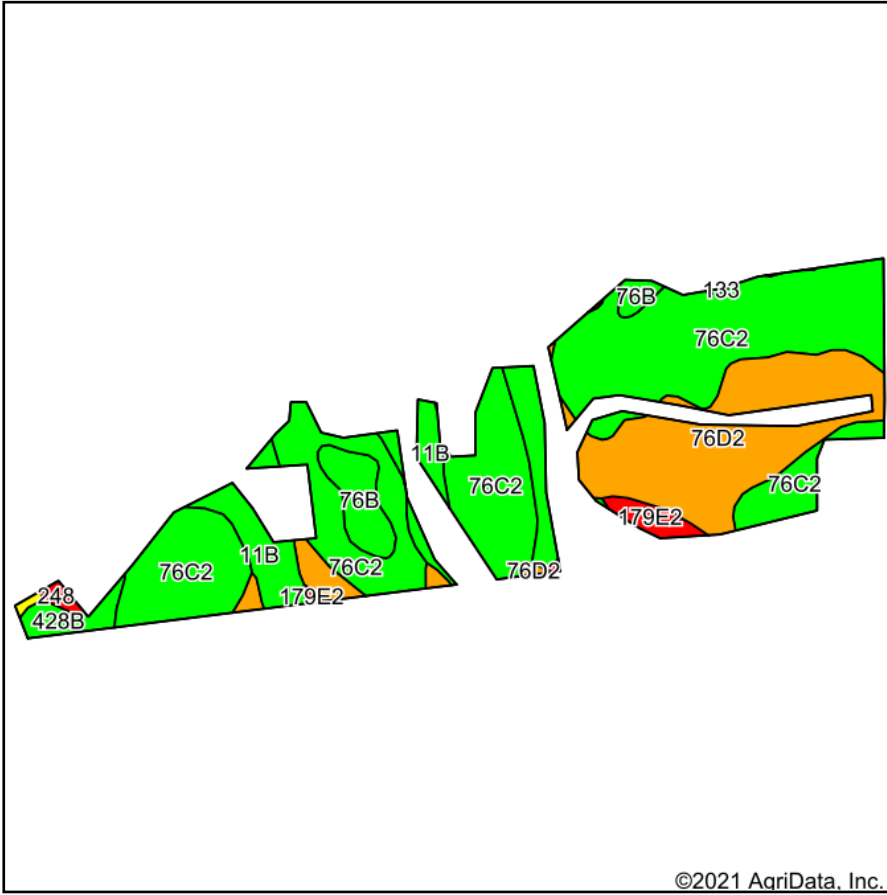

Soils data provided by USDA and NRCS.

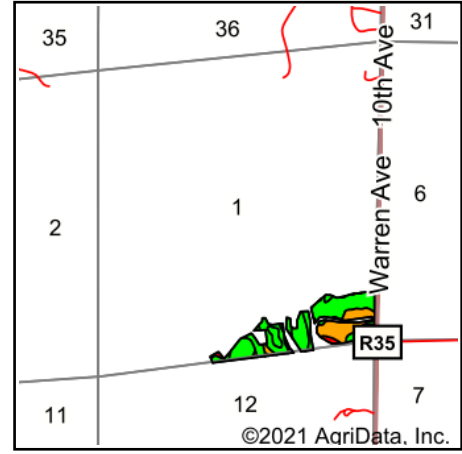

State: **Iowa**  
 County: **Madison**  
 Location: **1-76N-26W**  
 Township: **Crawford**  
 Acres: **34.98**  
 Date: **2/19/2021**



Maps Provided By:



© AgriData, Inc. 2021

www.AgriDataInc.com



Code	Soil Description	Acres	Percent of field	CSR2 Legend	Non-Irr Class *c	CSR2**
76C2	Ladoga silt loam, dissected till plain, 5 to 9 percent slopes, eroded	19.73	56.4%		IIIe	75
76D2	Ladoga silt loam, 9 to 14 percent slopes, eroded	8.35	23.9%		IIIe	49
11B	Colo, occasionally flooded-Ely silty clay loams, dissected till plain, 2 to 5 percent slopes	3.60	10.3%		IIw	80
76B	Ladoga silt loam, 2 to 5 percent slopes	1.62	4.6%		IIe	86
428B	Ely silty clay loam, dissected till plain, 2 to 5 percent slopes	0.75	2.1%		IIe	88
179E2	Gara loam, dissected till plain, 14 to 18 percent slopes, eroded	0.65	1.9%		VIe	32
248	Wabash silty clay loam	0.20	0.6%		IIIw	37
54	Zook silty clay loam, 0 to 2 percent slopes, occasionally flooded	0.08	0.2%		IIw	67
<b>Weighted Average</b>						<b>69.1</b>

\*\*IA has updated the CSR values for each county to CSR2.

\*c: Using Capabilities Class Dominant Condition Aggregation Method

Soils data provided by USDA and NRCS.