

Soils Map - Total Acres

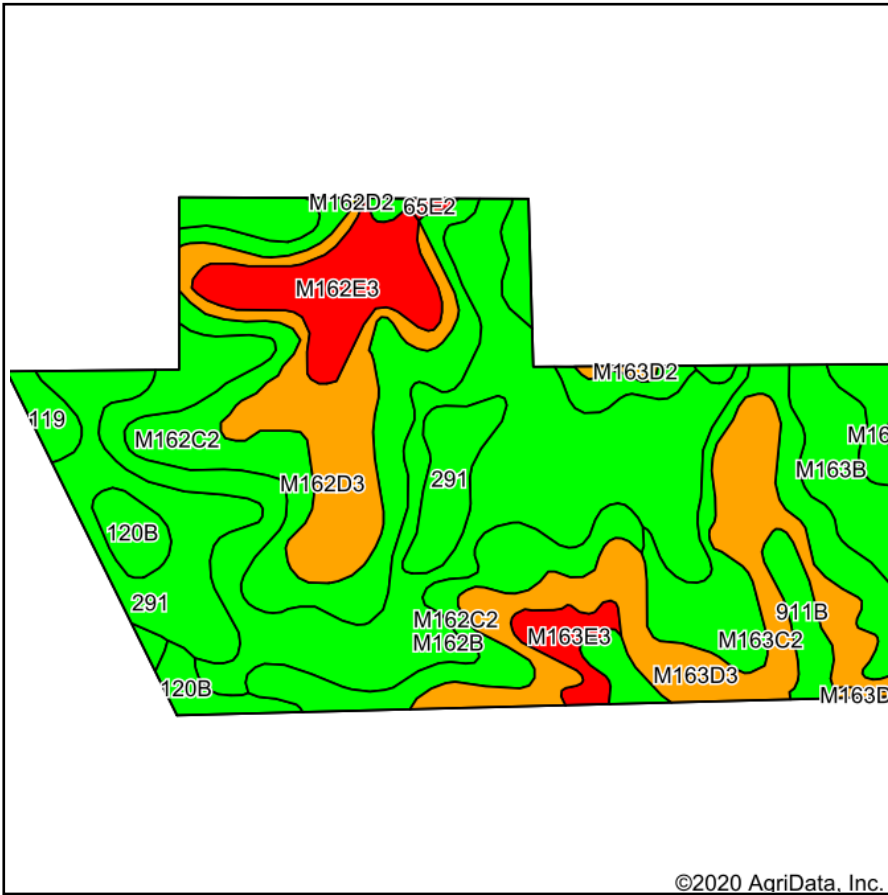

©2020 AgriData, Inc.

Soils data provided by USDA and NRCS.

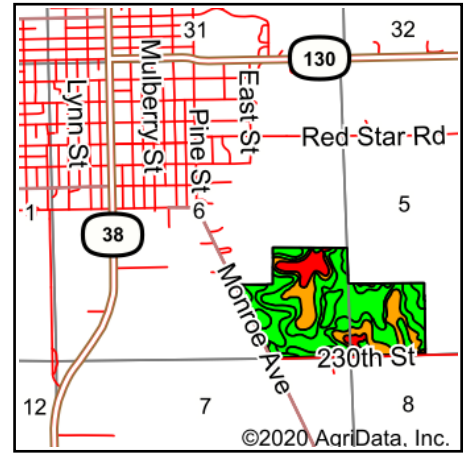

©2020 AgriData, Inc.

State: **Iowa**
 County: **Cedar**
 Location: **6-80N-2W**
 Township: **Center**
 Acres: **111.11**
 Date: **12/10/2020**



Maps Provided By:



© AgriData, Inc. 2020

www.AgriDataInc.com



Code	Soil Description	Acres	Percent of field	CSR2 Legend	Non-Irr Class *c	*i Corn	*i Alfalfa	*i Soybeans	CSR2**	Corn	Oats	Soybeans	*n NCCPI Corn	*n NCCPI Soybeans
M162B	Downs silt loam, till plain, 2 to 5 percent slopes	28.75	25.9%		Ile	0	0	0	90				94	81
M162C2	Downs silt loam, till plain, 5 to 9 percent slopes, eroded	20.68	18.6%		IIle	0	0	0	82				86	69
M163D3	Fayette silty clay loam, till plain, 9 to 14 percent slopes, severely eroded	12.70	11.4%		IVe	0	0	0	41				73	56
291	Atterberry silt loam, 0 to 2 percent slopes	10.40	9.4%		Iw	224	5.8	65	90				98	96
M162D3	Downs silty clay loam, till plain, 9 to 14 percent slopes, severely eroded	9.24	8.3%		IVe	0	0	0	50				76	53
M163C2	Fayette silt loam, till plain, 5 to 9 percent slopes, eroded	8.99	8.1%		IIle	0	0	0	76	9	4	3	84	70
M162E3	Downs silty clay loam, till plains, 14 to 18 percent slopes, severely eroded	6.22	5.6%		VIe	0	0	0	39				73	50
M163B	Fayette silt loam, till plain, 2 to 5 percent slopes	4.19	3.8%		Ile	0	0	0	84	9	4	3	90	80
911B	Colo-Ely complex, 0 to 5 percent slopes	3.15	2.8%		IIw	204.8	4.3	59.4	86				92	76
120B	Tama silty clay loam, 2 to 5 percent slopes	2.87	2.6%		Ile	232	6.5	67.3	95				97	80
M163E3	Fayette silty clay loam, till plain, 14 to 18 percent slopes, severely eroded	1.91	1.7%		VIe	0	0	0	29				69	52
119	Muscatine silty clay loam, 0 to 2 percent slopes	1.37	1.2%		Iw	240	6.2	69.6	100				96	91
M163D2	Fayette silt loam, till plain, 9 to 14 percent slopes, eroded	0.43	0.4%		IIle	0	0	0	47				77	63



65E2	Lindley loam, 14 to 18 percent slopes, moderately eroded	0.21	0.2%		Vle	134.4	3.8	39	31	15	4	3	68	55
Weighted Average						36	0.9	10.4	74.2	1.1	0.5	0.4	*n 86.4	*n 71.7

**IA has updated the CSR values for each county to CSR2.

*i Yield data provided by the ISPAID Database version 8.1.1 developed by IA State University.

*n: The aggregation method is "Weighted Average using all components"

*c: Using Capabilities Class Dominant Condition Aggregation Method

Soils data provided by USDA and NRCS.