

# Soils Map - Tillable Acres

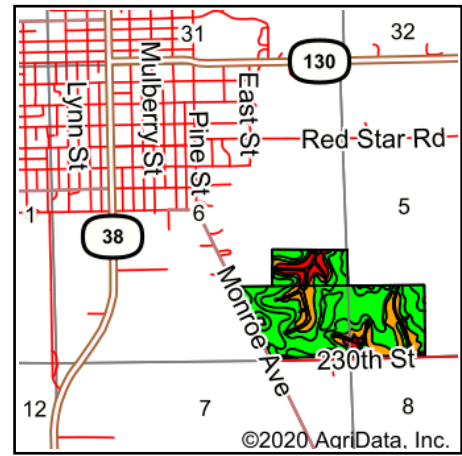

State: **Iowa**  
 County: **Cedar**  
 Location: **6-80N-2W**  
 Township: **Center**  
 Acres: **109.58**  
 Date: **12/10/2020**

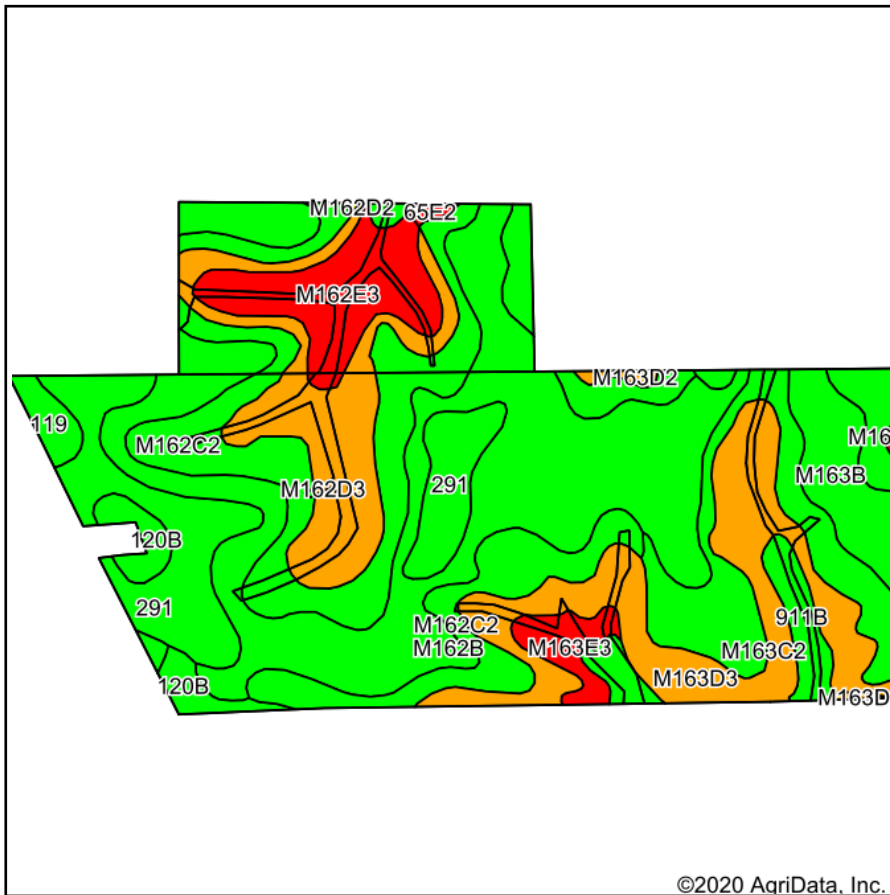

Soils data provided by USDA and NRCS.

©2020 AgriData, Inc.

© AgriData, Inc. 2020

www.AgriDataInc.com

Code	Soil Description	Acres	Percent of field	CSR2 Legend	Non-Irr Class *c	*i Corn	*i Alfalfa	*i Soybeans	CSR2**	Corn	Oats	Soybeans	*n NCCPI Corn	*n NCCPI Soybeans
M162B	Downs silt loam, till plain, 2 to 5 percent slopes	28.89	26.4%	Green	Ile	0	0	0	90				94	81
M162C2	Downs silt loam, till plain, 5 to 9 percent slopes, eroded	20.52	18.7%	Green	IIle	0	0	0	82				86	69
M163D3	Fayette silty clay loam, till plain, 9 to 14 percent slopes, severely eroded	12.22	11.2%	Yellow	IVe	0	0	0	41				73	56
291	Atterberry silt loam, 0 to 2 percent slopes	10.19	9.3%	Green	Iw	224	5.8	65	90				98	96
M162D3	Downs silty clay loam, till plain, 9 to 14 percent slopes, severely eroded	9.25	8.4%	Yellow	IVe	0	0	0	50				76	53
M163C2	Fayette silt loam, till plain, 5 to 9 percent slopes, eroded	9.12	8.3%	Green	IIle	0	0	0	76	9	4	3	84	70
M162E3	Downs silty clay loam, till plains, 14 to 18 percent slopes, severely eroded	6.22	5.7%	Red	VIe	0	0	0	39				73	50
M163B	Fayette silt loam, till plain, 2 to 5 percent slopes	4.27	3.9%	Green	Ile	0	0	0	84	9	4	3	90	80
911B	Colo-Ely complex, 0 to 5 percent slopes	3.02	2.8%	Green	IIw	204.8	4.3	59.4	86				92	76
120B	Tama silty clay loam, 2 to 5 percent slopes	2.14	2.0%	Green	Ile	232	6.5	67.3	95				97	80
M163E3	Fayette silty clay loam, till plain, 14 to 18 percent slopes, severely eroded	1.86	1.7%	Red	VIe	0	0	0	29				69	52
119	Muscatine silty clay loam, 0 to 2 percent slopes	1.28	1.2%	Green	Iw	240	6.2	69.6	100				96	91
M163D2	Fayette silt loam, till plain, 9 to 14 percent slopes, eroded	0.38	0.3%	Yellow	IIle	0	0	0	47				77	63



65E2	Lindley loam, 14 to 18 percent slopes, moderately eroded	0.22	0.2%		Vle	134.4	3.8	39	31	15	4	3	68	55
<b>Weighted Average</b>						<b>34.1</b>	<b>0.9</b>	<b>9.9</b>	<b>74.2</b>	<b>1.1</b>	<b>0.5</b>	<b>0.4</b>	<b>*n 86.3</b>	<b>*n 71.6</b>

\*\*IA has updated the CSR values for each county to CSR2.

\*i Yield data provided by the ISPAID Database version 8.1.1 developed by IA State University.

\*n: The aggregation method is "Weighted Average using all components"

\*c: Using Capabilities Class Dominant Condition Aggregation Method

Soils data provided by USDA and NRCS.