

Tillable Soils Map

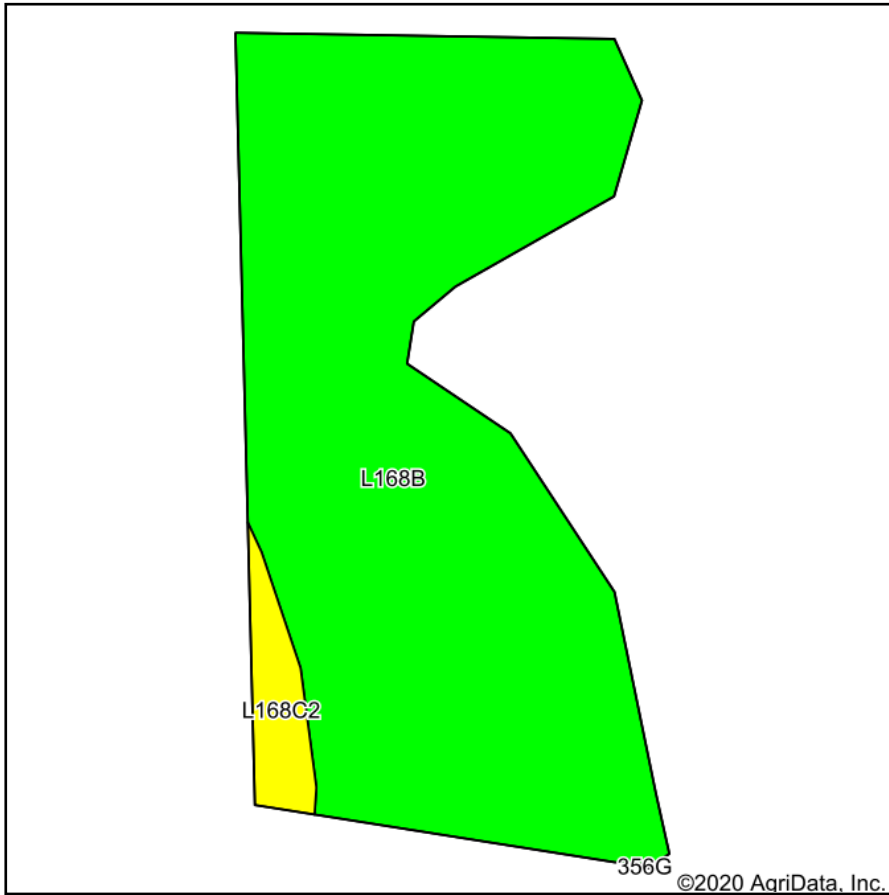

Soils data provided by USDA and NRCS.

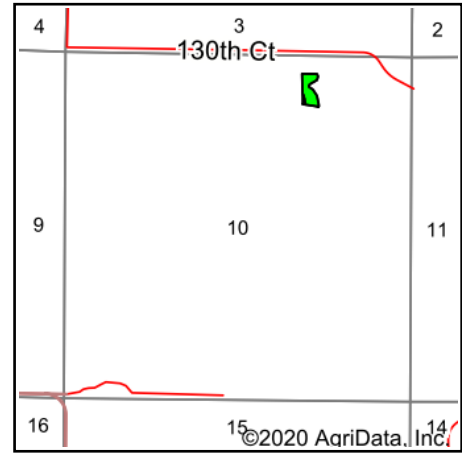

State: **Iowa**
 County: **Dallas**
 Location: **10-81N-26W**
 Township: **Des Moines**
 Acres: **2.19**
 Date: **12/14/2020**



Maps Provided By:



© AgriData, Inc. 2020

www.AgriDataInc.com



Code	Soil Description	Acres	Percent of field	CSR2 Legend	Non-Irr Class *c	*i Corn	*i Soybeans	CSR2**	*n NCCPI Overall
L168B	Hayden loam, Bemis moraine, 2 to 6 percent slopes	2.09	95.4%		Ile	0	0	76	86
L168C2	Hayden loam, Bemis moraine, 6 to 10 percent slopes, moderately eroded	0.10	4.6%		IIle	0	0	70	78
Weighted Average						*-	*-	75.7	*n 85.6

**IA has updated the CSR values for each county to CSR2.

*i Yield data provided by the ISPAID Database version 8.1.1 developed by IA State University.

*n: The aggregation method is "Weighted Average using all components"

*c: Using Capabilities Class Dominant Condition Aggregation Method

Soils data provided by USDA and NRCS.