

Tillable Soils Map

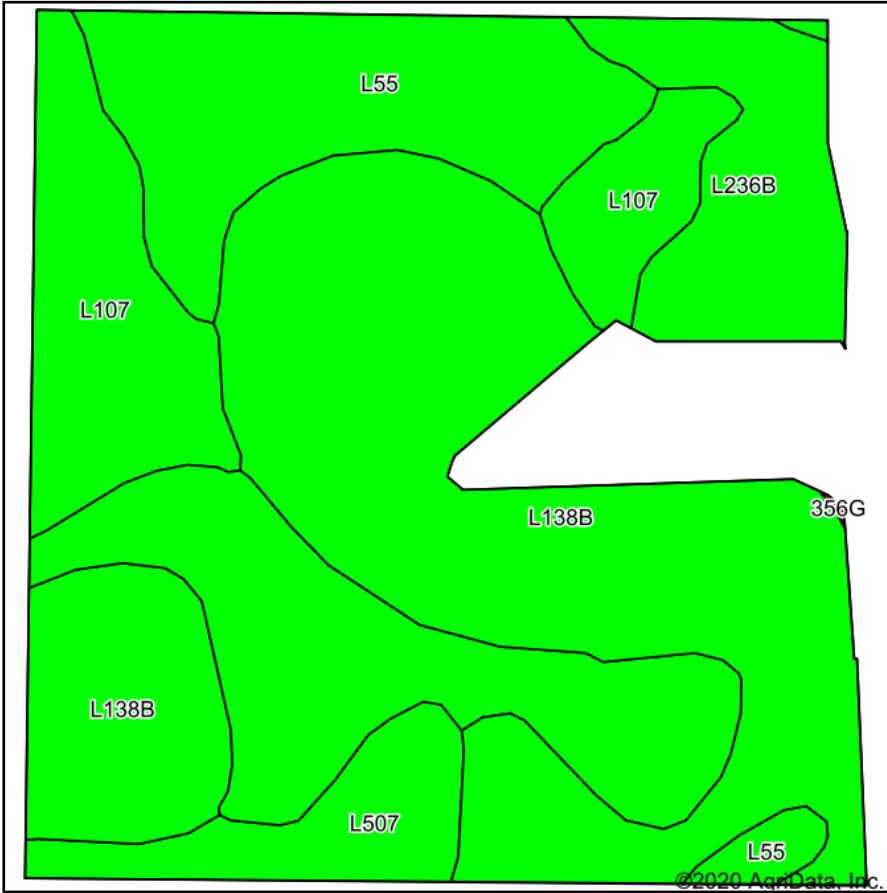

Soils data provided by USDA and NRCS.

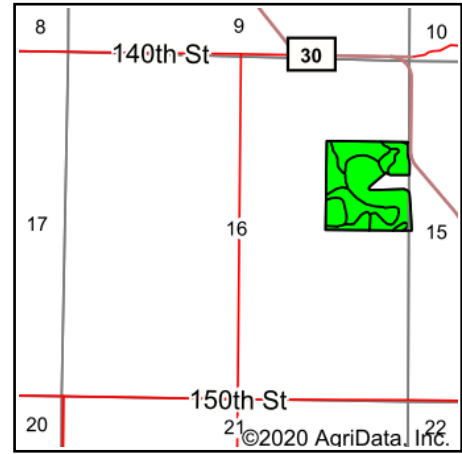

State: **Iowa**
 County: **Dallas**
 Location: **16-81N-26W**
 Township: **Des Moines**
 Acres: **37.54**
 Date: **10/14/2020**



Maps Provided By:



© AgriData, Inc. 2020

www.AgriDataInc.com



Area Symbol: IA049. Soil Area Version: 26										
Code	Soil Description	Acres	Percent of field	CSR2 Legend	Non-Irr Class *c	*i Corn	*i Soybeans	CSR2**	CSR	*n NCCPI Overall
L138B	Clarion loam, Bemis moraine, 2 to 6 percent slopes	16.22	43.2%		Ile	80	23.2	88		80
L55	Nicollet loam, 1 to 3 percent slopes	11.29	30.1%		Ie	0	0	91		85
L107	Webster clay loam, Bemis moraine, 0 to 2 percent slopes	4.91	13.1%		Ilw	0	0	88		84
L236B	Lester loam, Bemis moraine, 2 to 6 percent slopes	3.12	8.3%		Ile	0	0	85		89
L507	Canisteo clay loam, Bemis moraine, 0 to 2 percent slopes	2.00	5.3%		Ilw	0	0	87		81
Weighted Average						34.6	10	88.6	*-	*n 82.8

**IA has updated the CSR values for each county to CSR2.

*- CSR weighted average cannot be calculated on the current soils data, use prior data version for csr values.

*i Yield data provided by the ISPAID Database version 8.1.1 developed by IA State University.

*n: The aggregation method is "Weighted Average using all components"

*c: Using Capabilities Class Dominant Condition Aggregation Method

Soils data provided by USDA and NRCS.