

Soils Map - CRP Acres

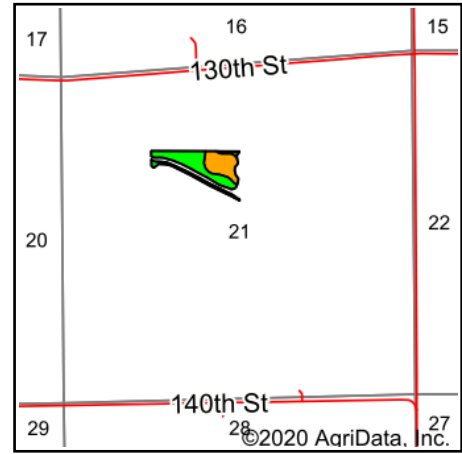

State: **Iowa**
 County: **Cedar**
 Location: **21-82N-1W**
 Township: **Massillon**
 Acres: **10.7**
 Date: **8/3/2020**



Maps Provided By:



Soils data provided by USDA and NRCS.

©2020 AgriData, Inc.

© AgriData, Inc. 2020

www.AgriDataInc.com

Area Symbol: IA031. Soil Area Version: 25															
Code	Soil Description	Acres	Percent of field	CSR2 Legend	Non-Irr Class *c	*i Corn	*i Alfalfa	*i Soybeans	CSR2**	CSR	*n NCCPI Overall	*n NCCPI Corn	*n NCCPI Small Grains	*n NCCPI Soybeans	
133	Colo silty clay loam, 0 to 2 percent slopes, occasionally flooded	6.36	59.4%		Ilw	204.8	4.3	59.4	78	80	77	77	34	75	
221	Klossner muck, 1 to 4 percent slopes	3.98	37.2%		Illw	80	1.7	23.2	48	45	88	88	68	87	
382	Maxfield silty clay loam, 0 to 2 percent slopes	0.36	3.4%		Ilw	230.4	4.8	66.8	87	90	79	79	53	68	
Weighted Average						159.2	3.3	46.2	67.1	67.3	*n 81.2	*n 81.2	*n 47.3	*n 79.2	

**IA has updated the CSR values for each county to CSR2.

*i Yield data provided by the ISPAID Database version 8.1.1 developed by IA State University.

*n: The aggregation method is "Weighted Average using all components"

*c: Using Capabilities Class Dominant Condition Aggregation Method

Soils data provided by USDA and NRCS.