

Soils Map

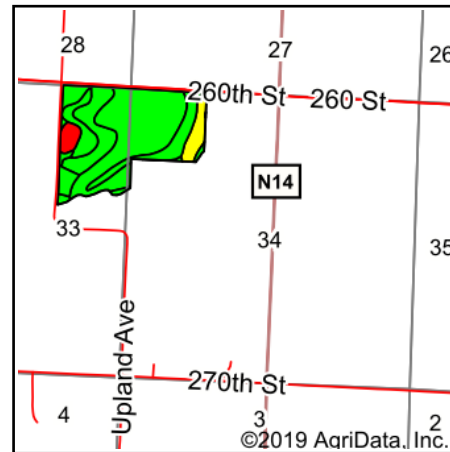

State: **Iowa**
 County: **Page**
 Location: **34-68N-36W**
 Township: **East River**
 Acres: **98.01**
 Date: **4/27/2020**

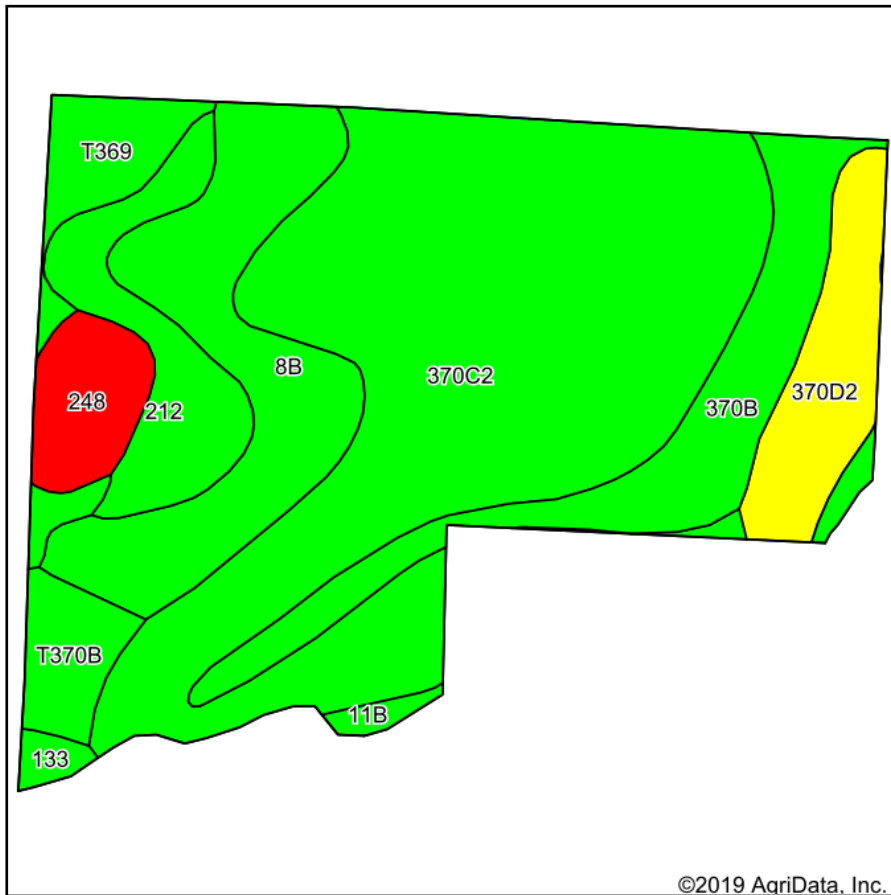

Maps Provided By:



Soils data provided by USDA and NRCS.

©2019 AgriData, Inc.

© AgriData, Inc. 2019

www.AgriDataInc.com

Area Symbol: IA145. Soil Area Version: 22							
Code	Soil Description	Acres	Percent of field	CSR2 Legend	Non-Irr Class *c	CSR2**	CSR
370C2	Sharpsburg silty clay loam, 5 to 9 percent slopes, eroded	46.80	47.8%		IIIe	80	65
8B	Judson silty clay loam, dissected till plain, 2 to 5 percent slopes	14.28	14.6%		IIe	93	84
370B	Sharpsburg silty clay loam, 2 to 5 percent slopes	10.77	11.0%		IIe	91	85
212	Kennebec silt loam, 0 to 2 percent slopes, occasionally flooded	6.84	7.0%		Iw	91	91
370D2	Sharpsburg silty clay loam, 9 to 14 percent slopes, eroded	6.48	6.6%		IIIe	54	55
T369	Winterset silty clay loam, 0 to 2 percent slopes	4.19	4.3%		IIw	83	85
248	Wabash silty clay loam, 0 to 1 percent slopes	3.79	3.9%		IIIw	38	60
T370B	Sharpsburg silty clay loam, terrace, 2 to 5 percent slopes	3.01	3.1%		IIe	91	85
11B	Colo-Judson silty clay loams, 0 to 5 percent slopes, occasionally flooded	1.14	1.2%		IIw	80	65
133	Colo silty clay loam, deep loess, 0 to 2 percent slopes, occasionally flooded	0.71	0.7%		IIw	78	80
Weighted Average						81	72.5

**IA has updated the CSR values for each county to CSR2.

*c: Using Capabilities Class Dominant Condition Aggregation Method

Soils data provided by USDA and NRCS.