

Soils Map

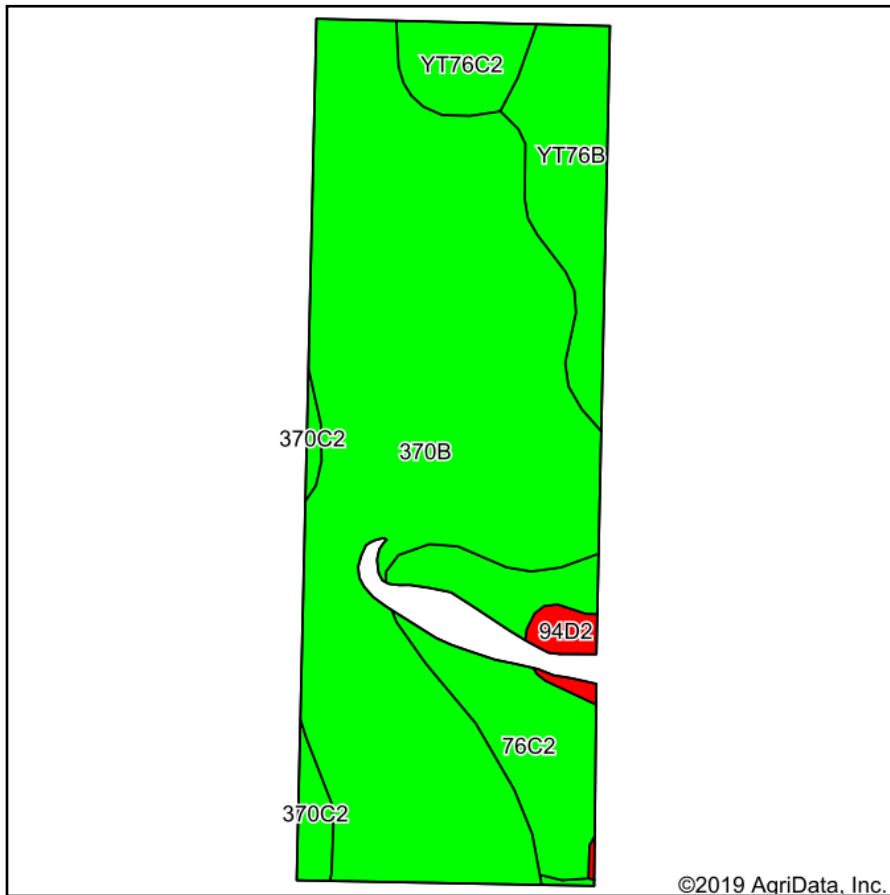

Soils data provided by USDA and NRCS.

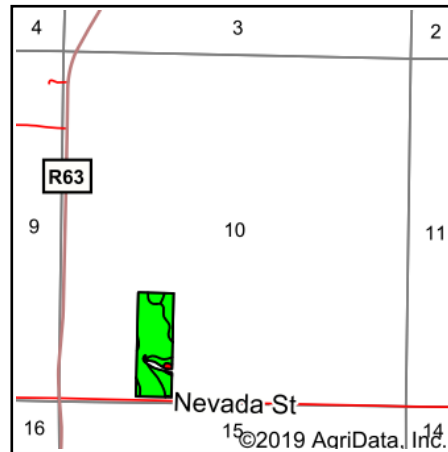

State: **Iowa**
 County: **Warren**
 Location: **10-75N-24W**
 Township: **White Oak**
 Acres: **19.27**
 Date: **3/2/2020**



Maps Provided By:



Area Symbol: IA181. Soil Area Version: 24													
Code	Soil Description	Acres	Percent of field	CSR2 Legend	Non-Irr Class *c	*i Corn	*i Soybeans	CSR2**	CSR	*n NCCPI Overall	*n NCCPI Corn	*n NCCPI Soybeans	
370B	Sharpsburg silty clay loam, 2 to 5 percent slopes	13.31	69.1%		Ile	225.6	65.4	91	87	93	93	77	
76C2	Ladoga silt loam, dissected till plain, 5 to 9 percent slopes, eroded	2.44	12.7%		IIle	192	55.7	75	65	64	64	63	
YT76B	Ladoga silt loam, terrace on dissected till plain, 2 to 5 percent slopes	1.93	10.0%		Ile			86		82	82	78	
YT76C2	Ladoga silt loam, terrace on dissected till plain, 5 to 9 percent slopes, eroded	0.83	4.3%		IIle			78		64	64	63	
370C2	Sharpsburg silty clay loam, 5 to 9 percent slopes, eroded	0.45	2.3%		IIle	204.8	59.4	80	67	71	71	63	
94D2	Mystic-Caleb complex, 9 to 14 percent slopes, moderately eroded	0.31	1.6%		IVe	120	34.8	25	25	61	61	48	
Weighted Average						186.8	54.2	86.6	*-	*n 85.9	*n 85.9	*n 73.9	

**IA has updated the CSR values for each county to CSR2.

*- CSR weighted average cannot be calculated on the current soils data, use prior data version for csr values.

*i Yield data provided by the ISPAID Database version 8.1.1 developed by IA State University.

*n: The aggregation method is "Weighted Average using major components"

*c: Using Capabilities Class Dominant Condition Aggregation Method

Soils data provided by USDA and NRCS.