

# Total Soils Map

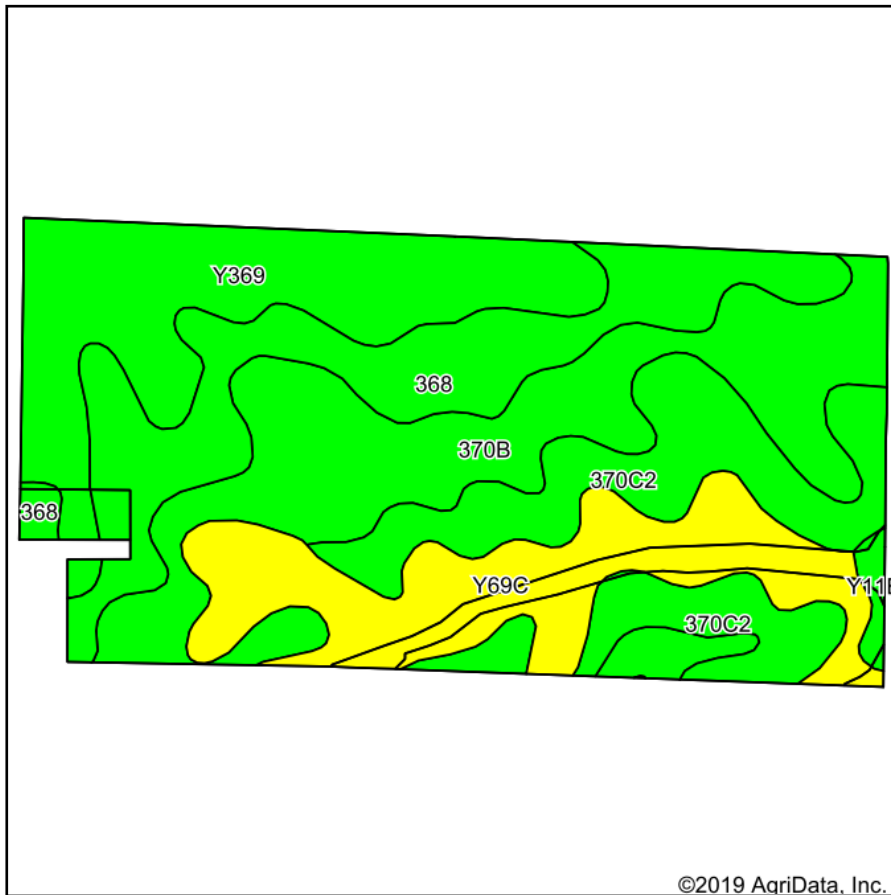

Soils data provided by USDA and NRCS.

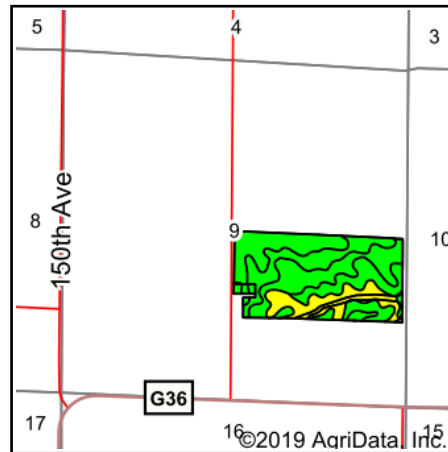

State: **Iowa**  
 County: **Warren**  
 Location: **9-76N-23W**  
 Township: **Lincoln**  
 Acres: **78**  
 Date: **2/28/2020**



Maps Provided By:



© AgriData, Inc. 2019

www.AgriDataInc.com

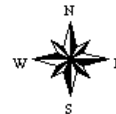

Area Symbol: IA181, Soil Area Version: 24										
Code	Soil Description	Acres	Percent of field	CSR2 Legend	Non-Irr Class *c	CSR2**	CSR	*n NCCPI Overall	*n NCCPI Soybeans	
370B	Sharpsburg silty clay loam, 2 to 5 percent slopes	19.99	25.6%		Ile	91	87	93	77	
Y369	Winterset silty clay loam, 0 to 2 percent slopes	15.35	19.7%		Ilw	83		79	72	
368	Macksburg silty clay loam, 0 to 2 percent slopes	14.40	18.5%		Iw	93	95	85	78	
370C2	Sharpsburg silty clay loam, 5 to 9 percent slopes, eroded	14.17	18.2%		IIIe	80	67	71	63	
Y69C	Clearfield silty clay loam, dissected till plain, 5 to 9 percent slopes	13.48	17.3%		IIIw	59		76	68	
Y11B	Colo, occasionally flooded-Ely silty clay loams, dissected till plain, 2 to 5 percent slopes	0.61	0.8%		Ilw	80		95	78	
<b>Weighted Average</b>						<b>82.2</b>	<b>*-</b>	<b>*n 81.8</b>	<b>*n 72.1</b>	

\*\*IA has updated the CSR values for each county to CSR2.

\*- CSR weighted average cannot be calculated on the current soils data, use prior data version for csr values.

\*n: The aggregation method is "Weighted Average using major components"

\*c: Using Capabilities Class Dominant Condition Aggregation Method

Soils data provided by USDA and NRCS.