

Soils Map

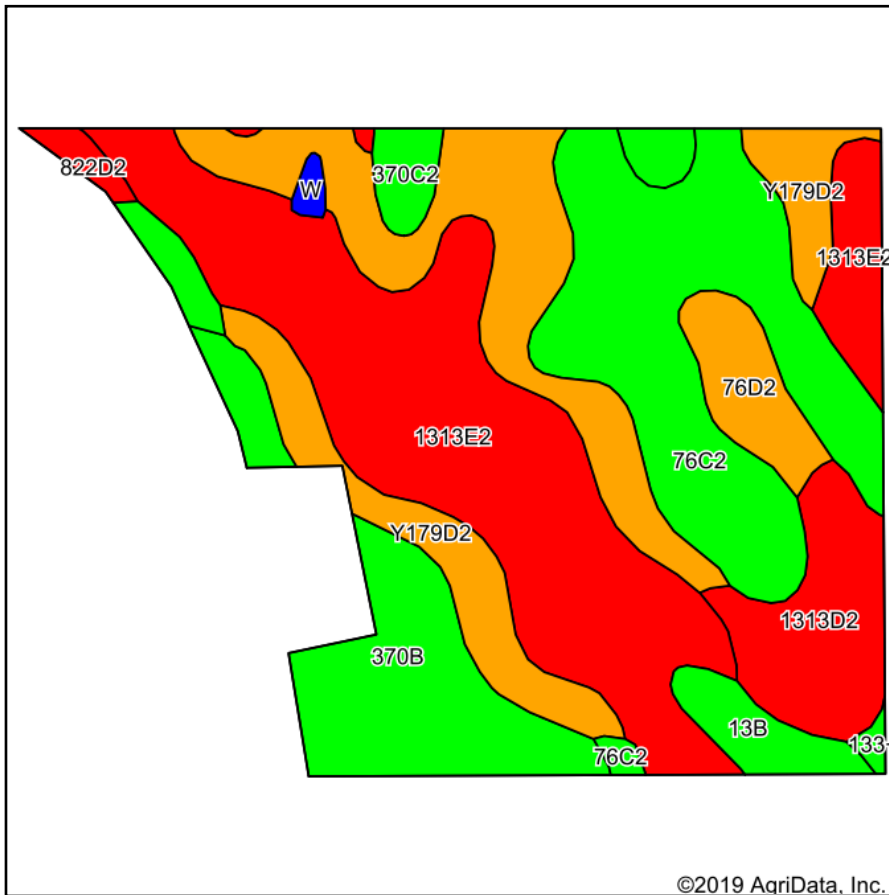

Soils data provided by USDA and NRCS.

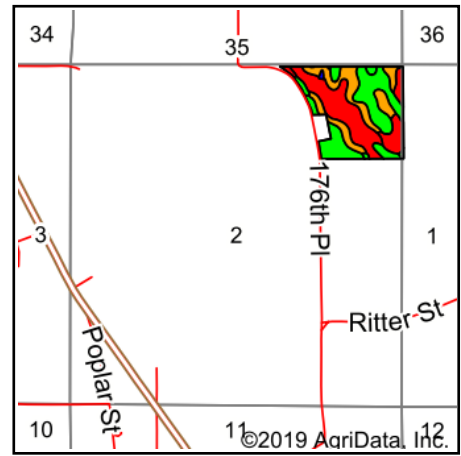

State: **Iowa**
 County: **Marion**
 Location: **2-74N-19W**
 Township: **Indiana**
 Acres: **49.67**
 Date: **9/12/2019**



Maps Provided By:



© AgriData, Inc. 2019

www.AgriDataInc.com



| Area Symbol: IA125. Soil Area Version: 27 | | | | | | | | | | | | |
|---|---|-------|------------------|-------------|------------------|--------------|-------------|-------------|----------|------------------|----------------|-------------------|
| Code | Soil Description | Acres | Percent of field | CSR2 Legend | Non-Irr Class *c | *i Corn | *i Soybeans | CSR2** | CSR | *n NCCPI Overall | *n NCCPI Corn | *n NCCPI Soybeans |
| 1313E2 | Munterville silt loam, 14 to 18 percent slopes, moderately eroded | 15.16 | 30.5% | | Vle | 80 | 23.2 | 22 | 5 | 45 | 45 | 36 |
| Y179D2 | Gara loam, dissected till plain, 9 to 14 percent slopes, eroded | 10.11 | 20.4% | | IVe | | | 43 | | 68 | 68 | 51 |
| 76C2 | Ladoga silt loam, 5 to 9 percent slopes, eroded | 9.82 | 19.8% | | IIIe | 192 | 55.7 | 75 | 65 | 76 | 76 | 64 |
| 370B | Sharpsburg silty clay loam, 2 to 5 percent slopes | 6.01 | 12.1% | | Ile | 225.6 | 65.4 | 91 | 87 | 93 | 93 | 77 |
| 1313D2 | Munterville silt loam, 9 to 14 percent slopes, moderately eroded | 3.49 | 7.0% | | Vle | 80 | 23.2 | 34 | 10 | 48 | 48 | 39 |
| 76D2 | Ladoga silt loam, 9 to 14 percent slopes, eroded | 1.74 | 3.5% | | IIIe | 163.2 | 47.3 | 49 | 55 | 72 | 72 | 60 |
| 370C2 | Sharpsburg silty clay loam, 5 to 9 percent slopes, eroded | 1.32 | 2.7% | | IIIe | 204.8 | 59.4 | 80 | 67 | 71 | 71 | 63 |
| 13B | Nodaway-Vesser silt loams, 2 to 5 percent slopes | 1.22 | 2.5% | | IIw | 190.4 | 55.2 | 79 | 63 | 91 | 91 | 83 |
| 822D2 | Lamoni silty clay loam, 9 to 14 percent slopes, moderately eroded | 0.45 | 0.9% | | IVe | 100.8 | 29.2 | 10 | 15 | 69 | 69 | 49 |
| W | Water | 0.19 | 0.4% | | | 0 | 0 | 0 | 0 | | 0 | 0 |
| 133+ | Colo silt loam, deep loess, 0 to 2 percent slopes, overwash, occasionally flooded | 0.16 | 0.3% | | IIw | 204.8 | 59.4 | 78 | 80 | 95 | 95 | 84 |
| Weighted Average | | | | | | 112.7 | 32.7 | 49.8 | * | *n 64.8 | *n 64.8 | *n 52.6 |

**IA has updated the CSR values for each county to CSR2.

*- CSR weighted average cannot be calculated on the current soils data, use prior data version for csr values.

*i Yield data provided by the ISPAID Database version 8.1.1 developed by IA State University.

*n: The aggregation method is "Weighted Average using major components"

*c: Using Capabilities Class Dominant Condition Aggregation Method

Soils data provided by USDA and NRCS.