

Soils Map

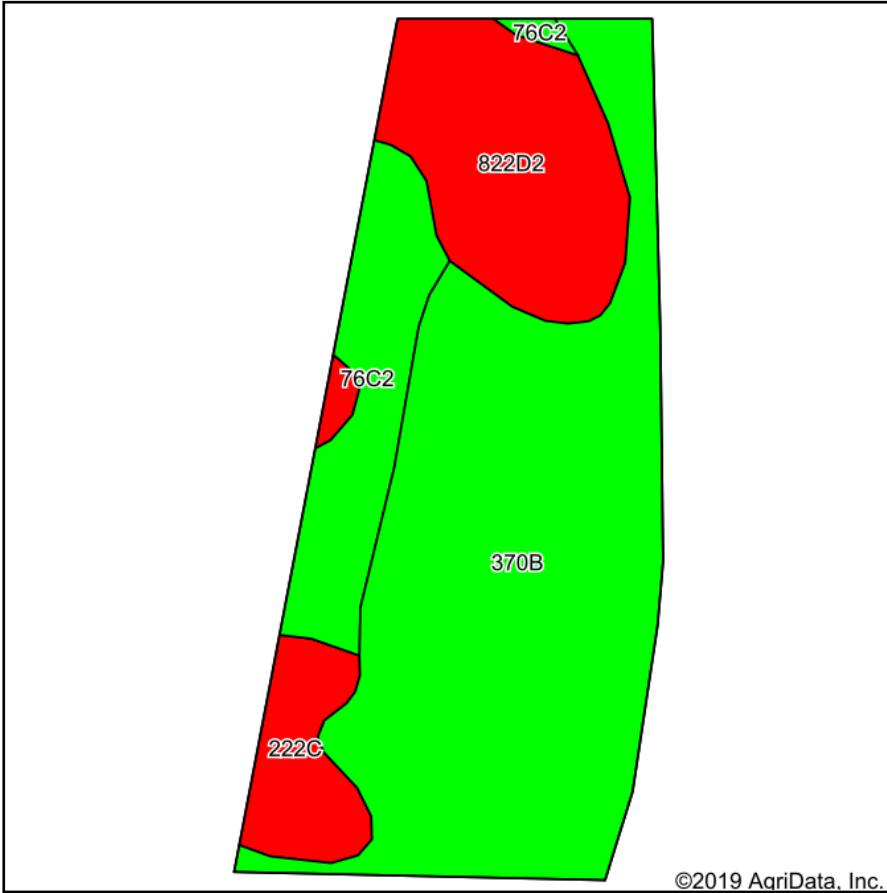

Soils data provided by USDA and NRCS.

©2019 AgriData, Inc.

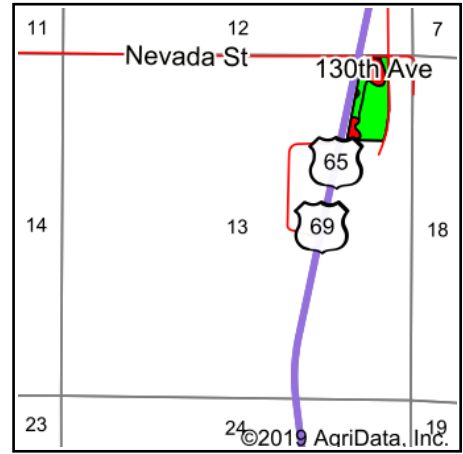

State: **Iowa**
 County: **Warren**
 Location: **13-75N-24W**
 Township: **White Oak**
 Acres: **15**
 Date: **8/15/2019**



Maps Provided By:



© AgriData, Inc. 2019

www.AgriDataInc.com



Area Symbol: IA181. Soil Area Version: 23

Code	Soil Description	Acres	Percent of field	CSR2 Legend	Non-Irr Class *c	CSR2**	CSR	*n NCCPI Overall	*n NCCPI Soybeans
370B	Sharpsburg silty clay loam, 2 to 5 percent slopes	9.05	60.3%	Green	Ile	91	87	93	77
822D2	Lamoni silty clay loam, 9 to 14 percent slopes, eroded	2.94	19.6%	Red	IVe	10	15	53	40
76C2	Ladoga silt loam, dissected till plain, 5 to 9 percent slopes, eroded	1.97	13.1%	Green	IIIe	75	65	64	63
222C	Clarinda silty clay loam, 5 to 9 percent slopes	1.04	6.9%	Red	IVw	31	30	53	45
Weighted Average						68.9	66	*n 78.6	*n 65.7

**IA has updated the CSR values for each county to CSR2.

*n: The aggregation method is "Weighted Average using major components"

*c: Using Capabilities Class Dominant Condition Aggregation Method

Soils data provided by USDA and NRCS.