

# Currently Farmed Soils Map

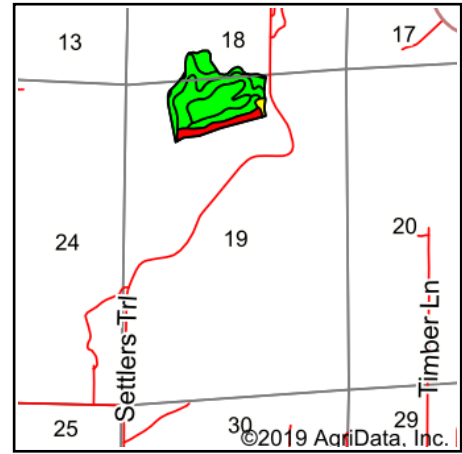

State: **Iowa**  
 County: **Madison**  
 Location: **19-75N-26W**  
 Township: **South**  
 Acres: **35.25**  
 Date: **7/16/2019**

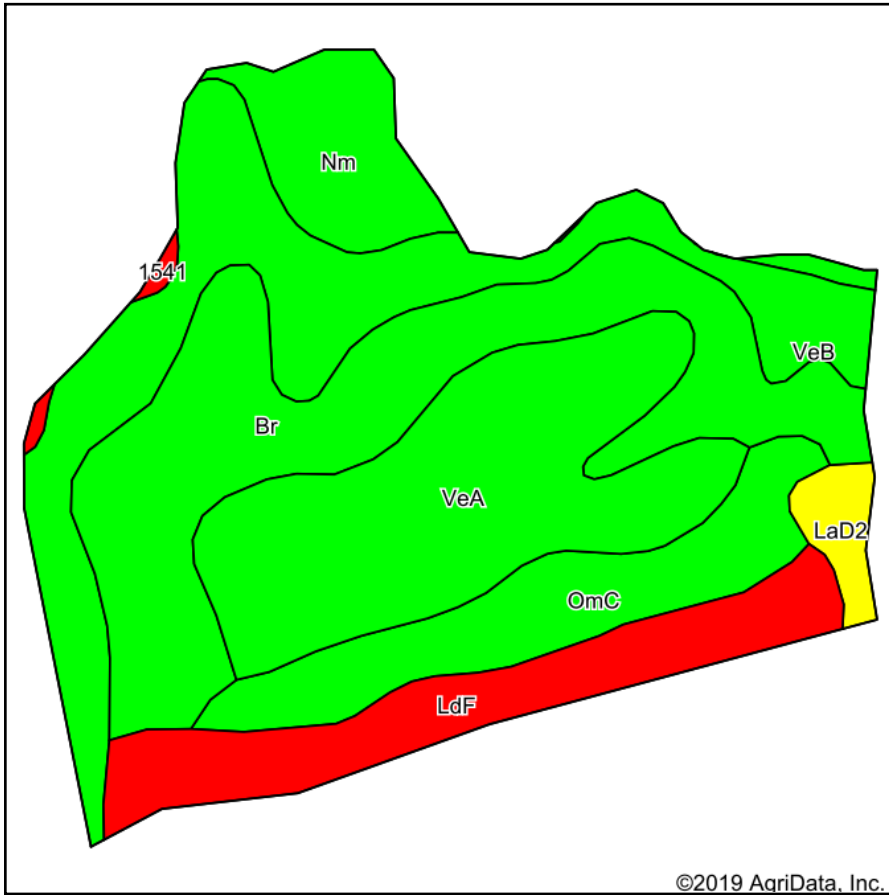

Soils data provided by USDA and NRCS.

©2019 AgriData, Inc.

© AgriData, Inc. 2019

www.AgriDataInc.com

Area Symbol: IA121, Soil Area Version: 22								
Code	Soil Description	Acres	Percent of field	CSR2 Legend	Non-Irr Class *c	CSR2**	CSR	
Br	Bremer silty clay loam	8.97	25.4%	<span style="background-color: #00FF00; border: 1px solid black;"> </span>	Ilw	74	82	
VeA	Vesser silt loam, 0 to 2 percent slopes	7.88	22.4%	<span style="background-color: #00FF00; border: 1px solid black;"> </span>	Ilw	74	70	
VeB	Vesser silt loam, 2 to 5 percent slopes	7.29	20.7%	<span style="background-color: #00FF00; border: 1px solid black;"> </span>	Ilw	69	65	
LdF	Lindley loam, 18 to 25 percent slopes	3.95	11.2%	<span style="background-color: #FF0000; border: 1px solid black;"> </span>	Vlle	14	10	
OmC	Olmitz loam, 5 to 9 percent slopes	3.87	11.0%	<span style="background-color: #00FF00; border: 1px solid black;"> </span>	Ille	85	57	
Nm	Nodaway silt loam, 0 to 2 percent slopes, occasionally flooded	2.45	7.0%	<span style="background-color: #00FF00; border: 1px solid black;"> </span>	Ilw	82	85	
LaD2	Ladoga silt loam, 9 to 14 percent slopes, eroded	0.69	2.0%	<span style="background-color: #FFFF00; border: 1px solid black;"> </span>	Ille	49	52	
1541	Quiver-Colo silty clay loams, 0 to 2 percent slopes, frequently flooded	0.15	0.4%	<span style="background-color: #FF0000; border: 1px solid black;"> </span>	Vw	12		
<b>Weighted Average</b>						<b>67.3</b>	<b>*-</b>	

\*\*IA has updated the CSR values for each county to CSR2.

\*- CSR weighted average cannot be calculated on the current soils data, use prior data version for csr values.

\*c: Using Capabilities Class Dominant Condition Aggregation Method

Soils data provided by USDA and NRCS.