

Tillable Soils Map

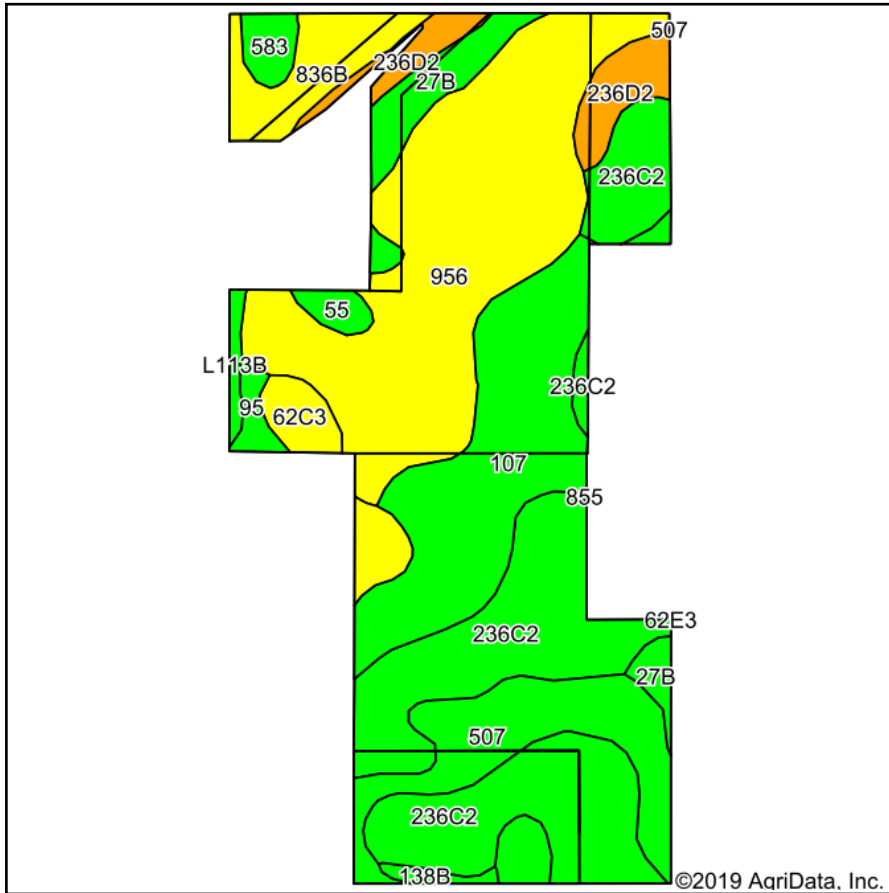

Soils data provided by USDA and NRCS.

©2019 AgriData, Inc.

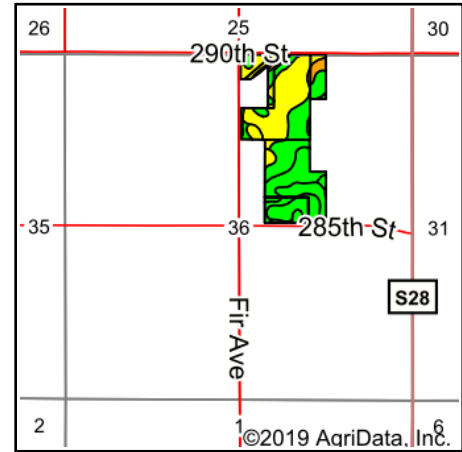

State: **Iowa**
 County: **Cerro Gordo**
 Location: **36-97N-22W**
 Township: **Grant**
 Acres: **54.93**
 Date: **4/14/2019**



© AgriData, Inc. 2019 www.AgriDataInc.com

Area Symbol: IA033, Soil Area Version: 21

Code	Soil Description	Acres	Percent of field	CSR2 Legend	Non-Irr Class *c	CSR2**	CSR	*n NCCPI Overall
956	Harps-Okoboji complex, 0 to 2 percent slopes	15.28	27.8%		IIw	69	57	78
236C2	Lester loam, 6 to 10 percent slopes, moderately eroded	14.12	25.7%		IIle	76	58	71
107	Webster clay loam, 0 to 2 percent slopes	8.96	16.3%		IIw	86	83	80
507	Canisteo clay loam, 0 to 2 percent slopes	5.53	10.1%		IIw	84	78	79
836B	Kilkenny clay loam, 2 to 6 percent slopes	2.44	4.4%		Ile	69	66	85
236D2	Lester loam, 10 to 16 percent slopes, moderately eroded	2.22	4.0%		IVe	49	48	66
27B	Terril loam, 2 to 6 percent slopes	2.09	3.8%		Ile	87	85	91
62C3	Storden loam, 6 to 10 percent slopes, moderately eroded	1.72	3.1%		IIle	64	46	65
583	Minnetonka silty clay loam, 0 to 2 percent slopes	0.71	1.3%		IIw	82	69	79
55	Nicollet clay loam, 1 to 3 percent slopes	0.70	1.3%		Iw	89	88	82
95	Harps clay loam, 0 to 2 percent slopes	0.50	0.9%		IIw	72	62	77
L113B	Reedslake-Le Sueur complex, 1 to 6 percent slopes	0.37	0.7%		Ile	85		82
138B	Clarion loam, 2 to 6 percent slopes	0.29	0.5%		Ile	89	80	83
Weighted Average						75.5	*	*n 76.6

**IA has updated the CSR values for each county to CSR2.

*- CSR weighted average cannot be calculated on the current soils data, use prior data version for csr values.

*n: The aggregation method is "Weighted Average using major components"

*c: Using Capabilities Class Dominant Condition Aggregation Method

Soils data provided by USDA and NRCS.