

Total Soils Map

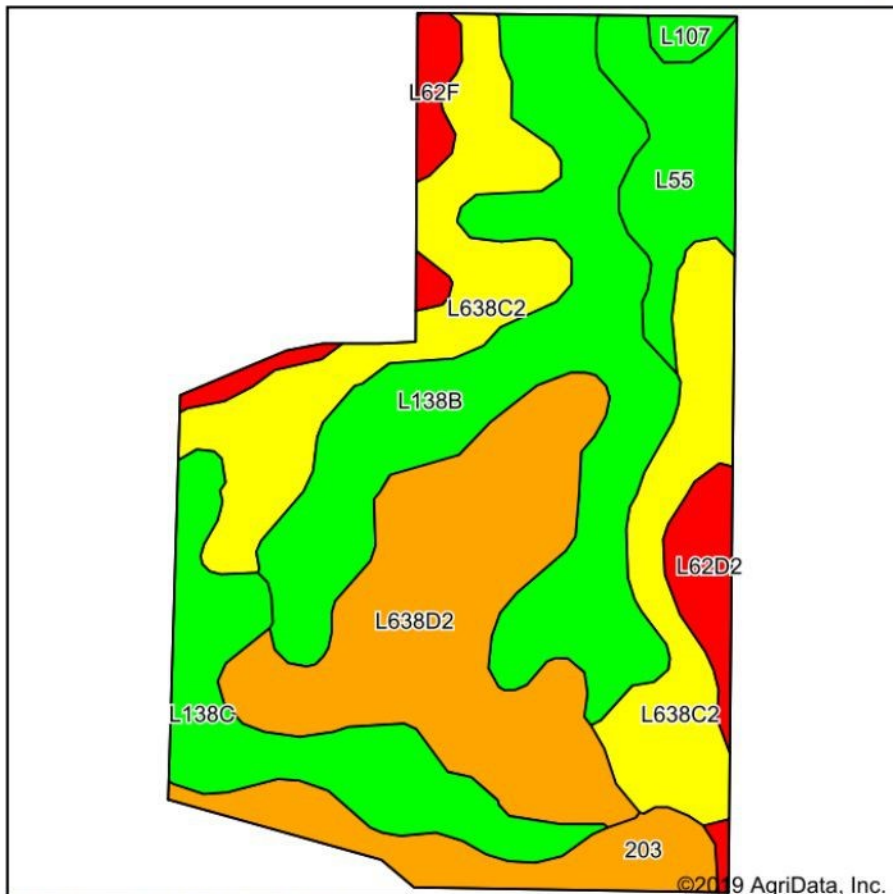

Soils data provided by USDA and NRCS.

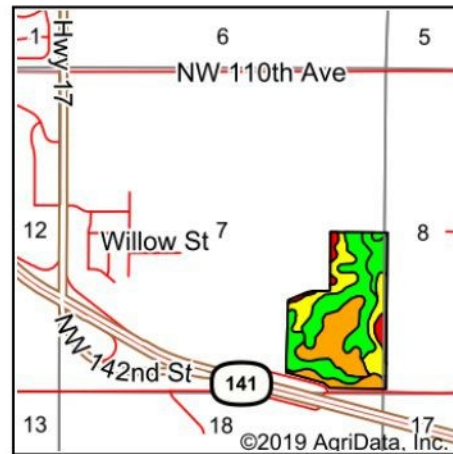

State: Iowa
 County: Polk
 Location: 7-80N-25W
 Township: Jefferson
 Acres: 79.64
 Date: 3/20/2019



Maps Provided By:



© AgriData, Inc. 2019

www.AgriDataInc.com



Area Symbol: IA153, Soil Area Version: 20

Code	Soil Description	Acres	Percent of field	CSR2 Legend	Non-Irr Class *c	CSR2**	CSR
L138B	Clarion loam, Bemis moraine, 2 to 6 percent slopes	20.88	26.2%	Green	Ile	88	
L638C2	Clarion-Storden complex, Bemis moraine, 6 to 10 percent slopes, moderately eroded	17.69	22.2%	Yellow	IIIe	75	
L638D2	Omsrud-Storden complex, Bemis moraine, 10 to 16 percent slopes, moderately eroded	16.88	21.2%	Orange	IVe	53	
L138C	Clarion loam, Bemis moraine, 6 to 10 percent slopes	8.64	10.8%	Green	IIIe	84	
L55	Nicollet loam, 1 to 3 percent slopes	5.40	6.8%	Green	Ie	91	
203	Cylinder loam, 0 to 2 percent slopes	5.08	6.4%	Orange	IIs	58	82
L62D2	Storden loam, Bemis moraine, 10 to 16 percent slopes, moderately eroded	2.44	3.1%	Red	IVe	41	
L62F	Belview loam, Bemis moraine, 16 to 30 percent slopes	2.01	2.5%	Red	VIe	16	
L107	Webster clay loam, Bemis moraine, 0 to 2 percent slopes	0.62	0.8%	Green	IIw	88	
Weighted Average						72.3	*-

**IA has updated the CSR values for each county to CSR2.

*- CSR weighted average cannot be calculated on the current soils data, use prior data version for csr values.

*c: Using Capabilities Class Dominant Condition Aggregation Method

Soils data provided by USDA and NRCS.