

# Tillable Soils Map

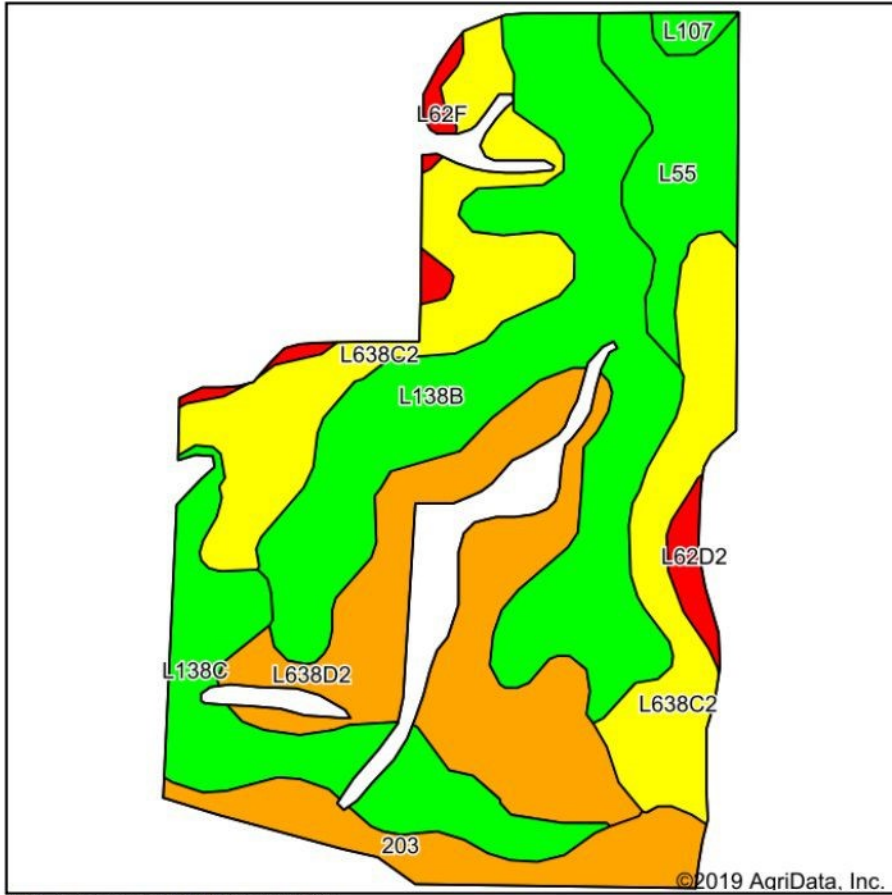

Soils data provided by USDA and NRCS.

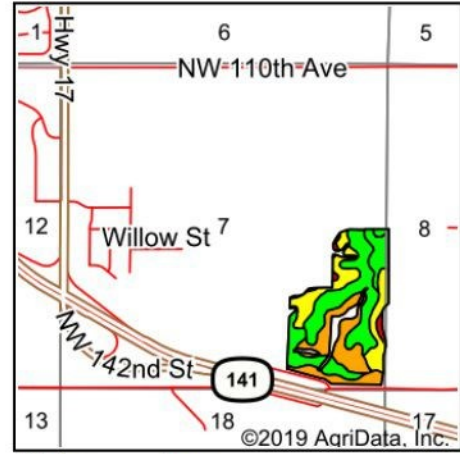

State: Iowa  
 County: Polk  
 Location: 7-80N-25W  
 Township: Jefferson  
 Acres: 70.81  
 Date: 3/20/2019



Maps Provided By:



© AgriData, Inc. 2019

www.AgriDataInc.com



Area Symbol: IA153, Soil Area Version: 20

Code	Soil Description	Acres	Percent of field	CSR2 Legend	Non-Irr Class *c	CSR2**	CSR
L138B	Clarion loam, Bemis moraine, 2 to 6 percent slopes	20.66	29.2%	Green	Ile	88	
L638C2	Clarion-Storden complex, Bemis moraine, 6 to 10 percent slopes, moderately eroded	16.18	22.8%	Yellow	IIIe	75	
L638D2	Omsrud-Storden complex, Bemis moraine, 10 to 16 percent slopes, moderately eroded	13.50	19.1%	Orange	IVe	53	
L138C	Clarion loam, Bemis moraine, 6 to 10 percent slopes	8.10	11.4%	Green	IIIe	84	
L55	Nicollet loam, 1 to 3 percent slopes	5.27	7.4%	Green	Ie	91	
203	Cylinder loam, 0 to 2 percent slopes	4.74	6.7%	Orange	IIs	58	82
L62F	Belview loam, Bemis moraine, 16 to 30 percent slopes	0.93	1.3%	Red	VIe	16	
L62D2	Storden loam, Bemis moraine, 10 to 16 percent slopes, moderately eroded	0.89	1.3%	Red	IVe	41	
L107	Webster clay loam, Bemis moraine, 0 to 2 percent slopes	0.54	0.8%	Green	IIw	88	
<b>Weighted Average</b>						<b>74.6</b>	<b>*-</b>

\*\*IA has updated the CSR values for each county to CSR2.

\*- CSR weighted average cannot be calculated on the current soils data, use prior data version for csr values.

\*c: Using Capabilities Class Dominant Condition Aggregation Method

Soils data provided by USDA and NRCS.