

Soils Map

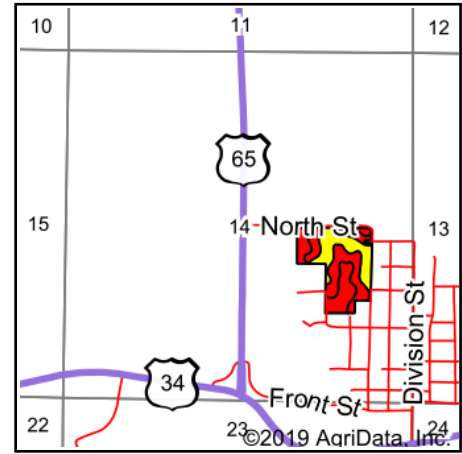
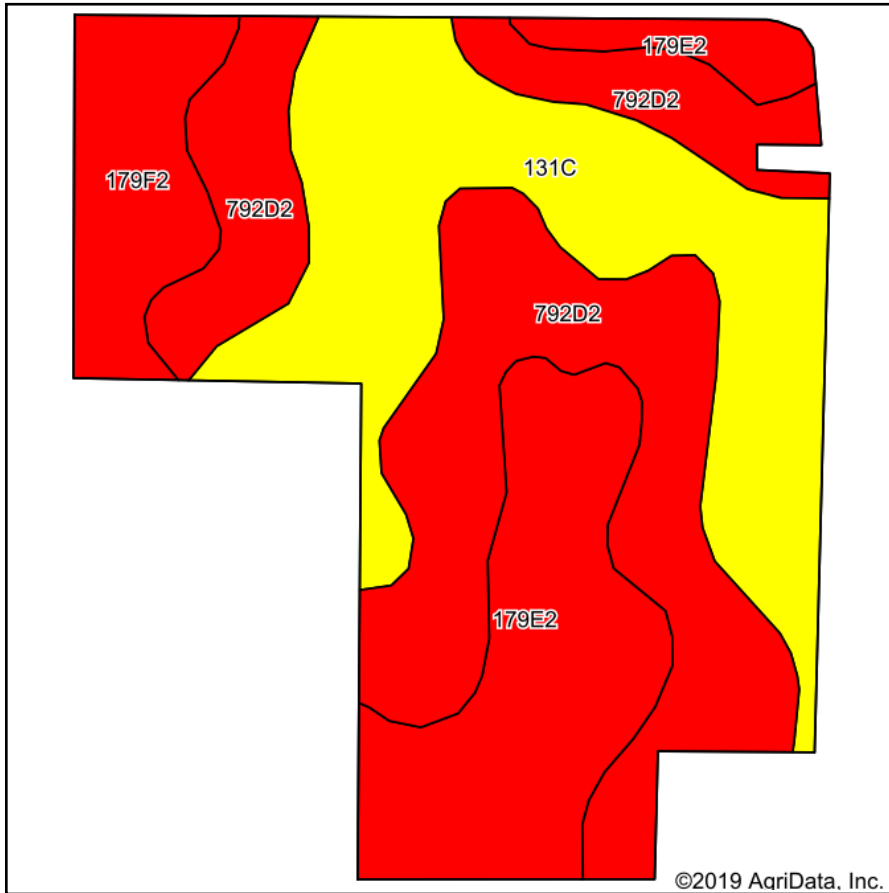

State: **Iowa**
 County: **Lucas**
 Location: **14-72N-23W**
 Township: **Jackson**
 Acres: **25**
 Date: **4/4/2019**

PC PEOPLES
COMPANY
 INNOVATIVE. REAL ESTATE. SOLUTIONS.

Maps Provided By:



© AgriData, Inc. 2019

www.AgriDataInc.com



Area Symbol: IA117, Soil Area Version: 26

| Code | Soil Description | Acres | Percent of field | CSR2 Legend | Non-Irr Class *c | *i Corn | *i Soybeans | CSR2** | CSR | *n NCCPI Overall | *n NCCPI Corn | *n NCCPI Soybeans |
|-------------------------|--|-------|------------------|-------------|------------------|-------------|-------------|-------------|-------------|------------------|---------------|-------------------|
| 792D2 | Armstrong clay loam, 9 to 14 percent slopes, moderately eroded | 9.47 | 37.9% | | IVe | 88 | 25.5 | 5 | 13 | 51 | 51 | 37 |
| 131C | Pershing silt loam, 5 to 9 percent slopes | 7.83 | 31.3% | | IIIe | 80 | 23.2 | 65 | 49 | 72 | 72 | 61 |
| 179E2 | Gara clay loam, 14 to 18 percent slopes, moderately eroded | 5.43 | 21.7% | | VIe | 139.2 | 40.4 | 23 | 33 | 55 | 55 | 40 |
| 179F2 | Gara clay loam, 18 to 25 percent slopes, moderately eroded | 2.27 | 9.1% | | IVe | 115.2 | 33.4 | 11 | 13 | 46 | 46 | 31 |
| Weighted Average | | | | | | 99.1 | 28.7 | 28.2 | 28.6 | *n 58 | *n 58 | *n 44.6 |

**IA has updated the CSR values for each county to CSR2.

*i Yield data provided by the ISPAID Database version 8.1.1 developed by IA State University.

*n: The aggregation method is "Weighted Average using major components"

*c: Using Capabilities Class Dominant Condition Aggregation Method

Soils data provided by USDA and NRCS.