

# Soils Map

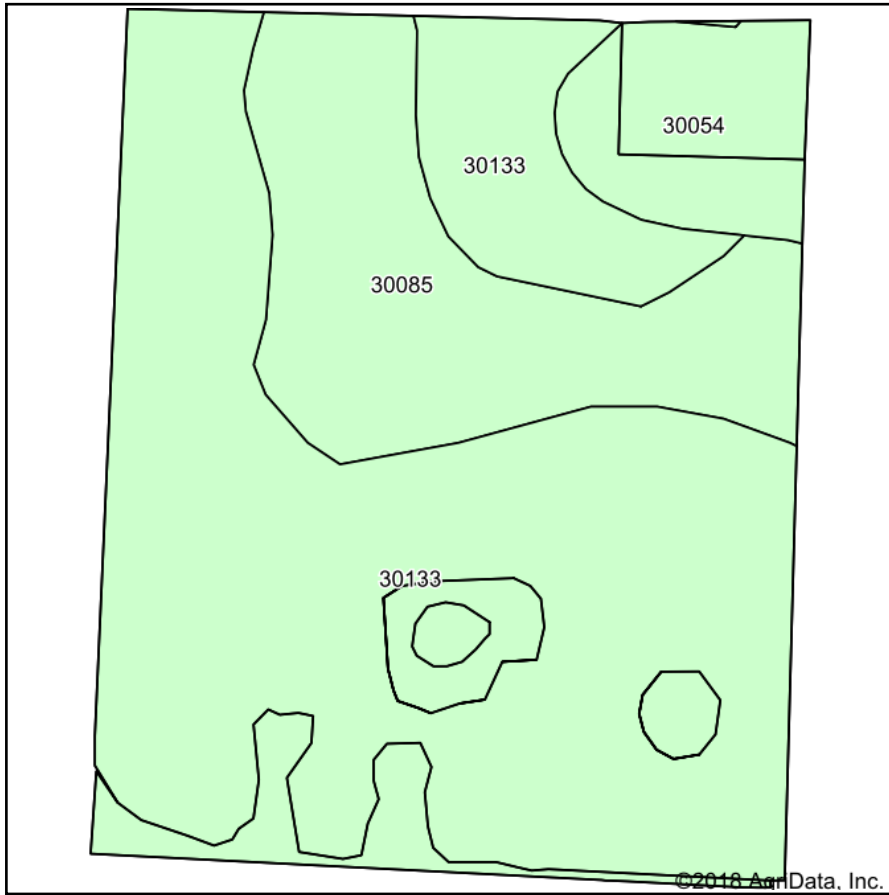

Soils data provided by USDA and NRCS.

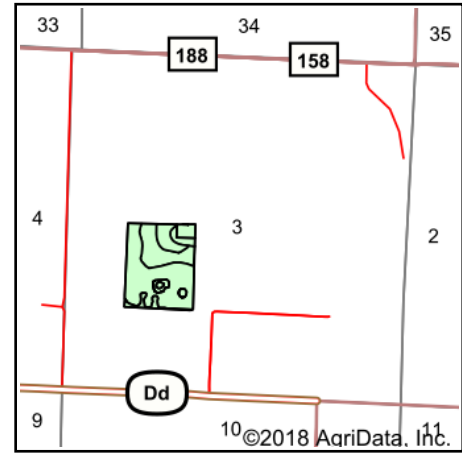

State: **Missouri**  
 County: **Gentry**  
 Location: **3-64N-30W**  
 Township: **Howard**  
 Acres: **32.5**  
 Date: **10/16/2018**



Maps Provided By:



© AgriData, Inc. 2018

www.AgriDataInc.com



## Area Symbol: MO075, Soil Area Version: 20

| Code                    | Soil Description   | Acres | Percent of field | Non-Irr Class *c | *n NCCPI Overall | *n NCCPI Soybeans |
|-------------------------|--|-------|------------------|------------------|------------------|-------------------|
| 30133                   | Lamoni clay loam, 5 to 9 percent slopes, moderately eroded | 22.89 | 70.4%            | IIIe             | 57               | 50                |
| 30085                   | Grundy silt loam, 2 to 5 percent slopes                    | 7.01  | 21.6%            | Ile              | 69               | 64                |
| 30054                   | Gara clay loam, 9 to 14 percent slopes, eroded             | 2.60  | 8.0%             | IVe              | 55               | 52                |
| <b>Weighted Average</b> |  |       |                  |                  | <b>*n 59.4</b>   | <b>*n 53.2</b>    |

\*n: The aggregation method is "Weighted Average using major components"

\*c: Using Capabilities Class Dominant Condition Aggregation Method

Soils data provided by USDA and NRCS.