

Total Soils Map

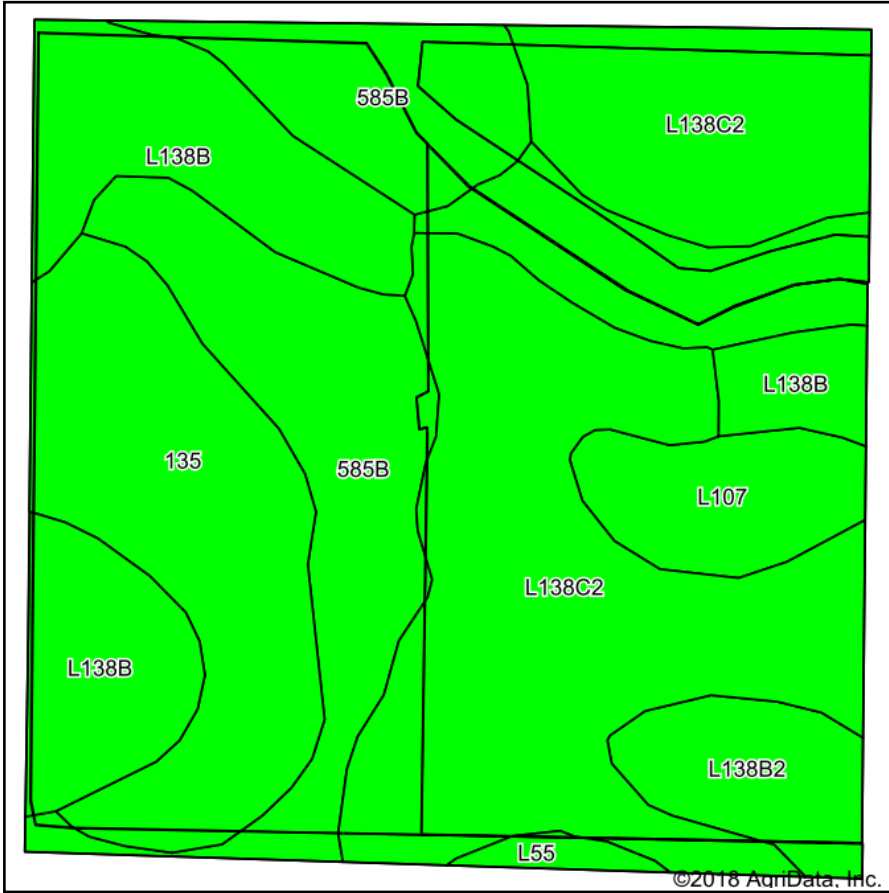

Soils data provided by USDA and NRCS.

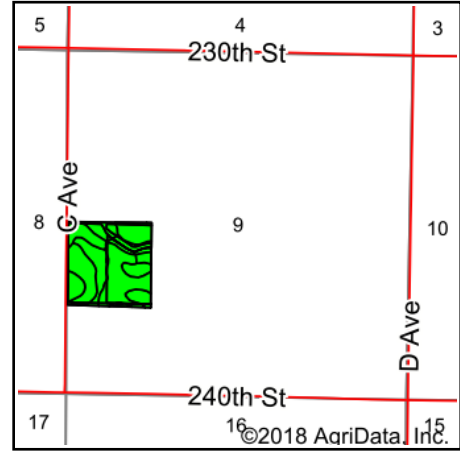

State: **Iowa**
 County: **Greene**
 Location: **9-83N-32W**
 Township: **Scranton**
 Acres: **37.76**
 Date: **10/5/2018**



Maps Provided By:



Area Symbol: IA073, Soil Area Version: 23

Code	Soil Description	Acres	Percent of field	CSR2 Legend	Non-Irr Class *c	CSR2**	CSR	NCCPI Overall	NCCPI Soybeans
L138C2	Clarion loam, Bemis moraine, 6 to 10 percent slopes, moderately eroded	13.06	34.6%		Ille	83		59	59
585B	Coland-Spillville complex, 1 to 5 percent slopes	7.00	18.5%		Ilw	74	70	93	88
L138B	Clarion loam, Bemis moraine, 2 to 6 percent slopes	5.86	15.5%		Ile	88		79	78
135	Coland clay loam, 0 to 2 percent slopes, occasionally flooded	5.69	15.1%		Ilw	76	81	86	78
L107	Webster clay loam, Bemis moraine, 0 to 2 percent slopes	4.15	11.0%		Ilw	88		80	80
L138B2	Clarion loam, Bemis moraine, 2 to 6 percent slopes, moderately eroded	1.72	4.6%		Ile	85		63	62
L55	Nicollet loam, 1 to 3 percent slopes	0.28	0.7%		Ile	91		83	83
Weighted Average						81.8	*-	75.1	72.8

**IA has updated the CSR values for each county to CSR2.

*- CSR weighted average cannot be calculated on the current soils data, use prior data version for csr values.

*c: Using Capabilities Class Dominant Condition Aggregation Method

Soils data provided by USDA and NRCS.