

Soils Map

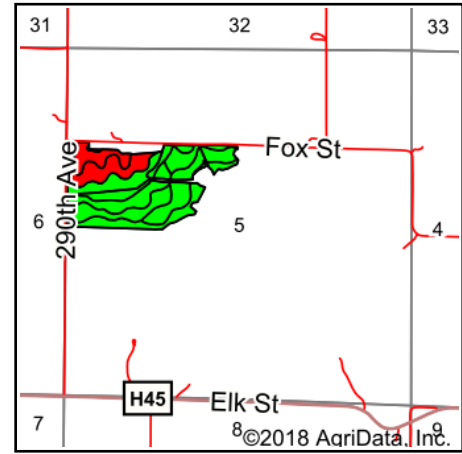
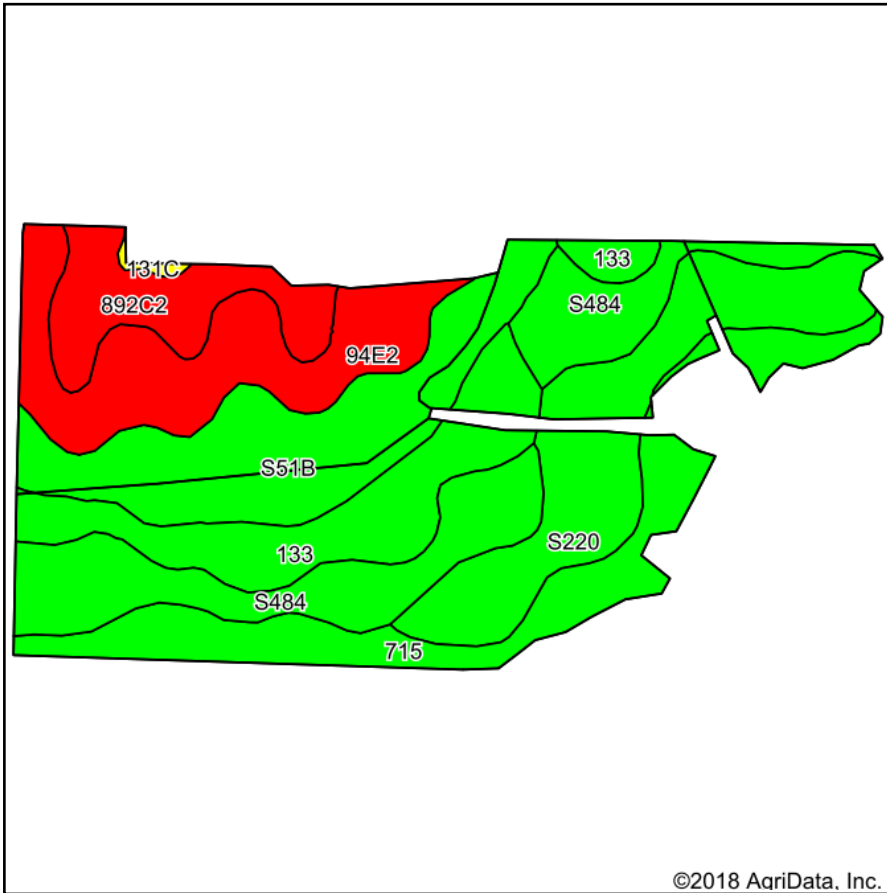

State: **Iowa**
 County: **Clarke**
 Location: **5-71N-24W**
 Township: **Franklin**
 Acres: **58.73**
 Date: **9/10/2018**

PEOPLES COMPANY
 INNOVATIVE. REAL ESTATE. SOLUTIONS.

Maps Provided By:

 CUSTOMIZED ONLINE MAPPING
 © AgriData, Inc. 2018 www.AgriDataInc.com



Soils data provided by USDA and NRCS.

©2018 AgriData, Inc.

Area Symbol: IA039, Soil Area Version: 23

Code	Soil Description	Acres	Percent of field	CSR2 Legend	Non-Irr Class *c	*i Corn	*i Soybeans	CSR2**	CSR	NCCPI Overall	NCCPI Corn	NCCPI Small Grains
S484	Lawson silt loam, heavy till, 0 to 2 percent slopes, occasionally flooded	10.48	17.8%		Ilw	0	0	86		88	86	35
S51B	Vesser silt loam, 2 to 5 percent slopes, rarely flooded	10.23	17.4%		Ilw	0	0	75		94	92	17
S220	Nodaway silt loam, heavy till, 0 to 2 percent slopes, occasionally flooded	9.52	16.2%		Ilw	0	0	77		83	83	63
94E2	Caleb-Mystic complex, 14 to 18 percent slopes, moderately eroded	8.32	14.2%		Vle	99.2	28.8	23	5	56	56	36
715	Nodaway-Lawson silt loams, heavy till, 0 to 2 percent slopes, occasionally flooded	7.86	13.4%		Ilw			74		88	85	45
133	Colo silty clay loam, heavy till, 0 to 2 percent slopes, occasionally flooded	7.73	13.2%		Ilw	204.8	59.4	78	80	94	94	15
892C2	Mystic variant silty clay loam, 5 to 9 percent slopes, moderately eroded	4.43	7.5%		Ive	115.2	33.4	34	16	55	55	44
131C	Pershing silt loam, 5 to 9 percent slopes	0.16	0.3%		Ille	80	23.2	65	49	72	72	44
Weighted Average						49.9	14.5	67.1	*-	82	80.9	36

**IA has updated the CSR values for each county to CSR2.

*- CSR weighted average cannot be calculated on the current soils data, use prior data version for csr values.

*i Yield data provided by the ISPAID Database version 8.1.1 developed by IA State University.

*c: Using Capabilities Class Dominant Condition Aggregation Method

Soils data provided by USDA and NRCS.