

# Soils Map

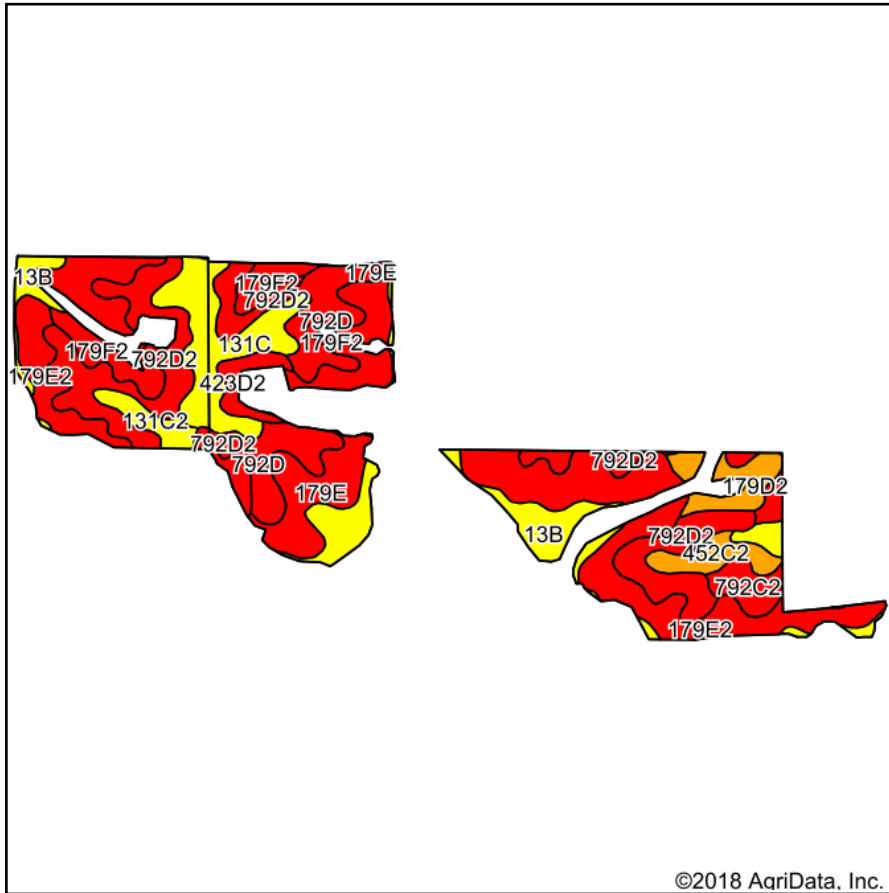

Soils data provided by USDA and NRCS.

©2018 AgriData, Inc.

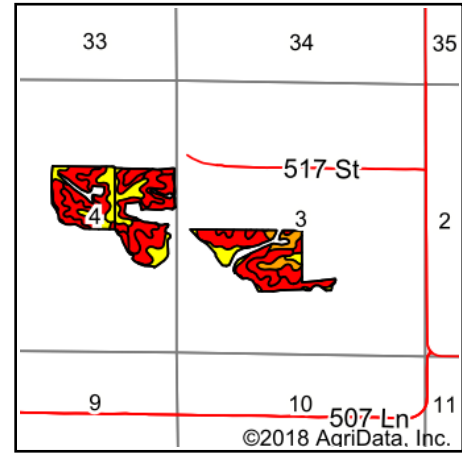

State: **Iowa**  
 County: **Lucas**  
 Location: **4-72N-23W**  
 Township: **Jackson**  
 Acres: **126.87**  
 Date: **8/28/2018**

**PEOPLES COMPANY**  
 INNOVATIVE. REAL ESTATE. SOLUTIONS.

Maps Provided By:



## Area Symbol: IA117, Soil Area Version: 25

Code	Soil Description	Acres	Percent of field	CSR2 Legend	Non-Irr Class *c	*i Corn	*i Soybeans	CSR2**	CSR	NCCPI Overall	NCCPI Corn	NCCPI Small Grains
179E2	Gara clay loam, 14 to 18 percent slopes, moderately eroded	27.38	21.6%		Vle	139.2	40.4	23	33	55	55	38
792D2	Armstrong clay loam, 9 to 14 percent slopes, moderately eroded	23.68	18.7%		IVe	88	25.5	5	13	51	51	38
179F2	Gara clay loam, 18 to 25 percent slopes, moderately eroded	16.57	13.1%		IVe	115.2	33.4	11	13	46	46	26
13B	Zook-Olmitz-Vesser complex, 0 to 5 percent slopes	11.32	8.9%		IIw	200	58	68	53	80	79	14
131C	Pershing silt loam, 5 to 9 percent slopes	11.19	8.8%		IIle	80	23.2	65	49	72	72	44
792D	Armstrong loam, 9 to 14 percent slopes	10.17	8.0%		IVe	99.2	28.8	28	18	70	70	43
179E	Gara loam, 14 to 18 percent slopes	8.35	6.6%		Vle	144	41.8	24	35	68	68	55
179D2	Gara clay loam, 9 to 14 percent slopes, moderately eroded	4.14	3.3%		IVe	163.2	47.3	45	43	64	64	44
423D2	Bucknell silty clay loam, 9 to 14 percent slopes, moderately eroded	3.74	2.9%		IVe	97.6	28.3	7	13	60	60	35
452C2	Lineville silt loam, 5 to 9 percent slopes, moderately eroded	3.49	2.8%		IIle	80	23.2	46	31	64	64	27
792C2	Armstrong clay loam, 5 to 9 percent slopes, moderately eroded	3.06	2.4%		IIle	123.2	35.7	24	27	53	53	34
131C2	Pershing silty clay loam, 5 to 9 percent slopes, moderately eroded	2.56	2.0%		IIle	80	23.2	62	45	59	59	35
23C2	Arispe silty clay loam, 5 to 9 percent slopes, moderately eroded	1.22	1.0%		IIle	80	23.2	62	50	82	82	49
<b>Weighted Average</b>						<b>119.6</b>	<b>34.7</b>	<b>28.3</b>	<b>28.7</b>	<b>59.8</b>	<b>59.8</b>	<b>36.1</b>

\*\*IA has updated the CSR values for each county to CSR2.

\*i Yield data provided by the ISPAID Database version 8.1.1 developed by IA State University.

\*c: Using Capabilities Class Dominant Condition Aggregation Method

Soils data provided by USDA and NRCS.