

Soils Map

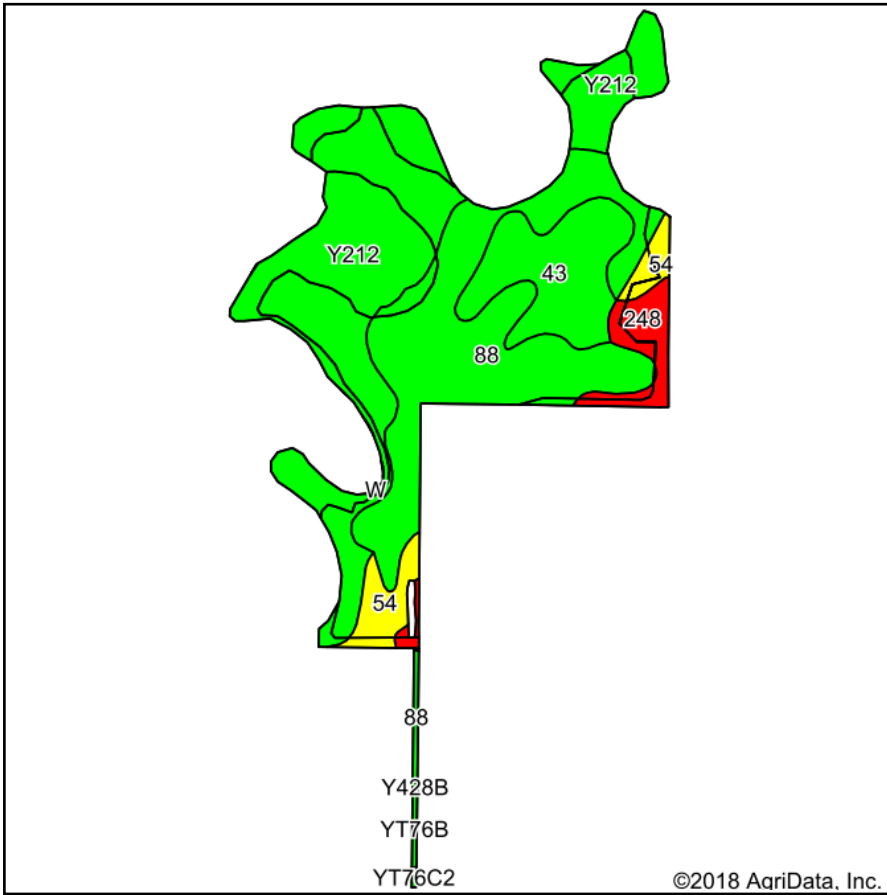

Soils data provided by USDA and NRCS.

©2018 AgriData, Inc.

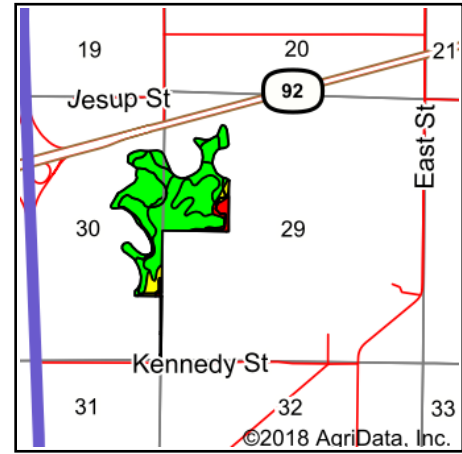

State: **Iowa**
 County: **Warren**
 Location: **29-76N-25W**
 Township: **Jefferson**
 Acres: **82.24**
 Date: **3/1/2018**

Maps Provided By:



Area Symbol: IA181, Soil Area Version: 22

Code	Soil Description	Acres	Percent of field	CSR2 Legend	Non-Irr Class *c	CSR2**	CSR
Y212	Kennebec silt loam, 0 to 2 percent slopes, occasionally flooded	35.31	42.9%	 	Iw	91	
88	Nevin silty clay loam, 0 to 2 percent slopes	27.67	33.6%	 	Iw	93	90
43	Bremer silty clay loam, 0 to 2 percent slopes	10.79	13.1%	 	IIw	74	82
54	Zook silty clay loam, 0 to 2 percent slopes, occasionally flooded	4.21	5.1%	 	IIw	67	70
248	Wabash silty clay loam, 0 to 2 percent slopes	3.96	4.8%	 	IIIw	38	60
YT76B	Ladoga silt loam, terrace on dissected till plain, 2 to 5 percent slopes	0.24	0.3%	 	Ile	86	
YT76C2	Ladoga silt loam, terrace on dissected till plain, 5 to 9 percent slopes, eroded	0.06	0.1%	 	IIle	78	
Weighted Average						85.6	*-

**IA has updated the CSR values for each county to CSR2.

*- CSR weighted average cannot be calculated on the current soils data, use prior data version for csr values.

*c: Using Capabilities Class Dominant Condition Aggregation Method

Soils data provided by USDA and NRCS.