

Tillable Soils Map

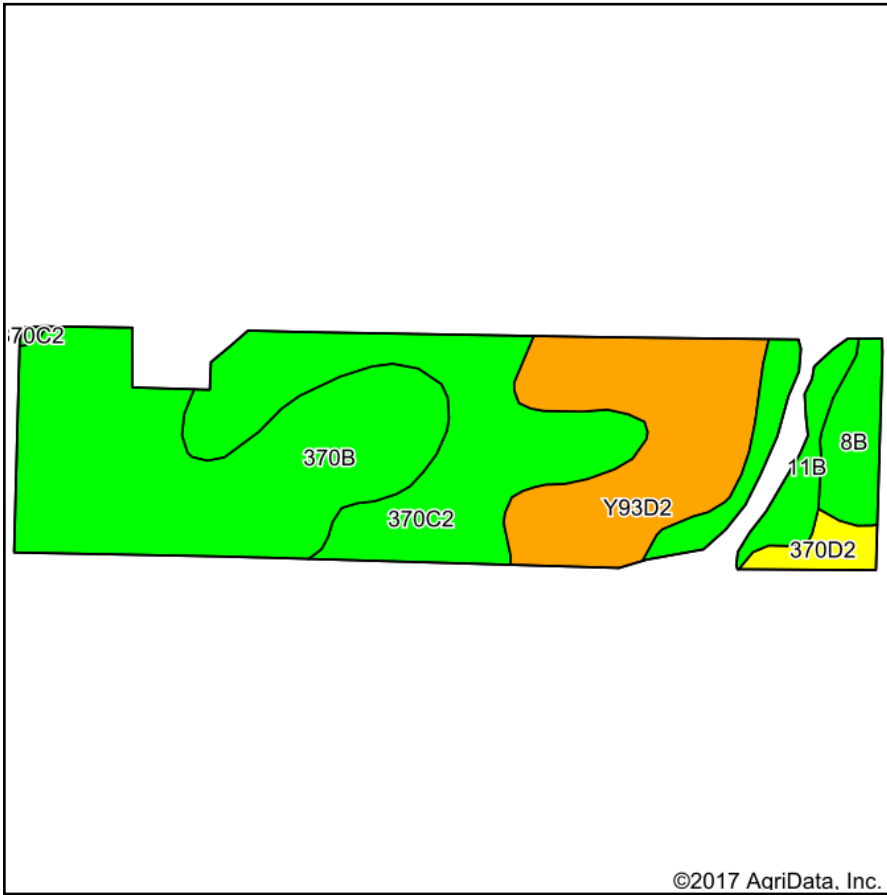

Soils data provided by USDA and NRCS.

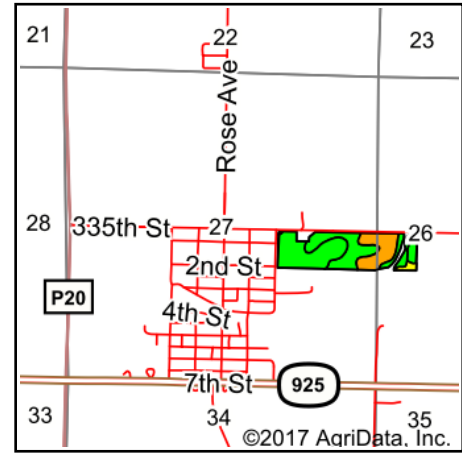

State: **Iowa**
 County: **Guthrie**
 Location: **27-78N-31W**
 Township: **Beaver**
 Acres: **31.93**
 Date: **12/6/2017**



Maps Provided By:



© AgriData, Inc. 2017

www.AgriDataInc.com



Area Symbol: IA077, Soil Area Version: 25

Code	Soil Description	Acres	Percent of field	CSR2 Legend	Non-Irr Class *c	CSR2**	CS R	NCCPI Overall
370B	Sharpsburg silty clay loam, 2 to 5 percent slopes	11.58	36.3%		Ile	90	87	93
370C2	Sharpsburg silty clay loam, 5 to 9 percent slopes, eroded	8.52	26.7%		IIIe	80	67	70
Y93D2	Shelby-Adair clay loams, dissected till plain, 9 to 14 percent slopes, eroded	7.00	21.9%		IIIe	41		61
11B	Colo-Judson silty clay loams, 0 to 5 percent slopes, occasionally flooded	2.46	7.7%		IIw	80	68	95
8B	Judson silty clay loam, dissected till plain, 2 to 5 percent slopes	1.56	4.9%		Ile	93	82	90
370D2	Sharpsburg silty clay loam, 9 to 14 percent slopes, eroded	0.81	2.5%		IIIe	54	57	66
Weighted Average						75.1	*-	79.2

**IA has updated the CSR values for each county to CSR2.

*- CSR weighted average cannot be calculated on the current soils data, use prior data version for csr values.

*c: Using Capabilities Class Dominant Condition Aggregation Method

Soils data provided by USDA and NRCS.